

## Troubleshooting

Symptom	Possible Cause	Solution
A Master Control appears not to be working.	• No power available to unit.	• Ensure power is turned on.
	• Master Control is not programmed into the system.	• See Activating Controls in the RadioRA® Setup Guide.

## FCC Information

**NOTE:** This equipment has been tested and found to comply with the limits for a Class B digital device, pursuant to part 15 of the FCC rules. These limits are designed to provide reasonable protection against harmful interference in a residential installation. This equipment generates, uses and can radiate radio frequency energy and, if not installed and used in accordance with the instructions, may cause harmful interference to radio or television reception, which can be determined by turning the equipment off and on, the user is encouraged to try to correct the interference by one or more of the following measures:

- Reorient or relocate the receiving antenna.
- Increase the separation between the equipment and receiver.
- Connect the equipment into an outlet on a circuit different from that to which the receiver is connected.
- Consult the dealer or an experienced radio/TV technician for help.

**Caution:** Changes or modifications not expressly approved by Lutron Electronics Co. could void the user's authority to operate this equipment.

## Technical Assistance

If you have questions concerning the installation or operation of this product, call the **Lutron Technical Support Center**. Please provide exact model number when calling.  
 (800) 523-9466 (U.S.A., Canada, and the Caribbean)  
 Other countries call (610) 282-3800  
 Fax (610) 282-3090  
 Visit our web site at [www.lutron.com](http://www.lutron.com)

## Limited Warranty

Lutron will, at its option, repair or replace any unit that is defective in materials or manufacture within one year after purchase. For warranty service, return unit to place of purchase or mail to Lutron at 7200 Suter Rd., Coopersburg, PA 18036-1299, postage pre-paid.

**THIS WARRANTY IS IN LIEU OF ALL OTHER EXPRESS WARRANTIES, AND THE IMPLIED WARRANTY OF MERCHANTABILITY IS LIMITED TO ONE YEAR FROM PURCHASE. THIS WARRANTY DOES NOT COVER THE COST OF INSTALLATION, REMOVAL OR REINSTALLATION, OR DAMAGE RESULTING FROM MISUSE, ABUSE, OR IMPROPER OR INCORRECT REPAIR, OR DAMAGE FROM IMPROPER WIRING OR INSTALLATION. THIS WARRANTY DOES NOT COVER INCIDENTAL OR CONSEQUENTIAL DAMAGES. LUTRON'S LIABILITY ON ANY CLAIM FOR DAMAGES ARISING OUT OF OR IN CONNECTION WITH THE MANUFACTURE, SALE, INSTALLATION, DELIVERY, OR USE OF THE UNIT SHALL NEVER EXCEED THE PURCHASE PRICE OF THE UNIT.**

This warranty gives you specific legal rights, and you may also have other rights which vary from state to state. Some states do not allow limitations on how long an implied warranty lasts, so the above limitation may not apply to you. Some states do not allow the exclusion or limitation of incidental or consequential damages, so the above limitation or exclusion may not apply to you.

This product may be covered under one or more of the following U.S. patents: 4,835,343; 4,954,768; 5,248,919; 5,399,940; 5,637,930; 5,736,965; 5,798,581; 5,838,226; 5,848,054; 5,905,442; 5,982,103; DES 353,798; DES 378,814; DES 389,461; DES 389,805; DES 395,037; DES 404,013; DES 422,969; DES 428,855; DES 436,579; DES 439,220 and corresponding foreign patents. U.S. and foreign patents pending. Lutron and RadioRA are registered trademarks of Lutron Electronics Co., Inc.  
 © 2001 Lutron Electronics Co., Inc.

Lutron Electronics Co., Inc.  
 7200 Suter Road  
 Coopersburg, PA 18036-1299, U.S.A.  
 Made and printed in the U.S.A. 8/01 P/N 044-017 Rev. A

# LUTRON®

English

P/N 044-017

# RadioRA®

Wireless Home Lighting Control

## Installation Instructions for Wall-Mounted Master Controls

*Please Leave for Occupant*

*Read all instructions completely before installation.*

### Important Notes

1. Install in accordance with all national and local electrical codes.
2. A neutral wire connection is required for the Wall-Mounted Master control.
3. Do not paint controls or wallplates.
4. **Clean with a *soft damp cloth only*.** Do not use any chemical cleaners.
5. Operate in ambient temperatures between 0°C (32°F) and 40°C (104°F).
6. Recommended wallbox depth is 2½" minimum.
7. The range and performance of the RadioRA® System is highly dependent on a variety of complex factors such as:
  - Distance between system components
  - Geometry of the home
  - Construction of walls separating system components
  - Electrical equipment located near system components
8. Do not mix RadioRA® "A" and "B" frequency products within the same system. Products with different frequencies **are not** compatible.

## Wall-Mounted Master Control

RAMC-5W, RAMC-10W, RAMC-15W  
 RBMC-5W, RBMC-10W, RBMC-15W  
 RAMC-5W-RL, RAMC-10W-RL, RAMC-15W-RL  
 RBMC-5W-RL, RBMC-10W-RL, RBMC-15W-RL

120/127VAC, 50/60Hz

## Table of Contents

### Installation



### Operation of the Master Control

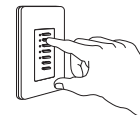

**Note:** Request Application Note #41 on how to retrofit a RadioRA® Wall-Mounted Master Control into an existing home.

# LUTRON®

# Installation

Installing a Wall-Mounted Master Control in a newly installed wallbox.

✓ **Check off Steps as completed.**

**Step 1** Turn power off at circuit breaker panel or remove fuse from fusebox.

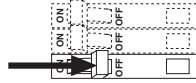

## Important Wiring Information

When making wire connections, follow the recommended strip lengths and combinations for the supplied wire connectors. **Note:** Wire connectors provided are suitable for **copper wire only**. For aluminum wire, consult an electrician.

**Small:**

- Strip insulation 3/8" for 14 AWG wire
- Strip insulation 1/2" for 16 or 18 AWG wire
- Use to join one 14 AWG supply wire with one 16 or 18 AWG control wire.

**Large:**

- Strip insulation 1/2" for 10, 12 or 14 AWG wire
- Strip insulation 5/8" for 16 or 18 AWG wire
- Use to join one or two 12 or 14 AWG supply wires with one 10, 12, 14, 16, or 18 AWG control wire.

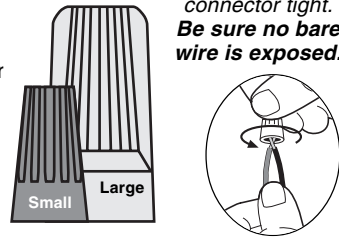

**Step 2** Wire the Control.

Using the wire connectors provided:

- Connect the master control **green** ground wire to the **green** or **bare copper** ground wire in the wallbox. If there is no ground wire in your wallbox, consult an electrician.
- Connect the **black** control wire to the **HOT** wire coming from the breaker panel.
- Connect the **white** control wire to the **NEUTRAL** wire coming from the breaker panel.

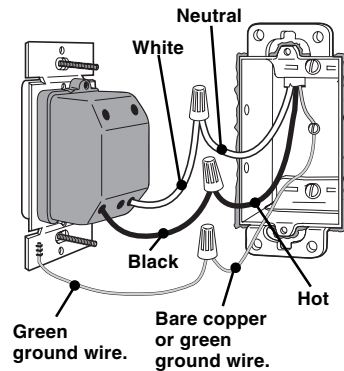

### Wiring Diagram

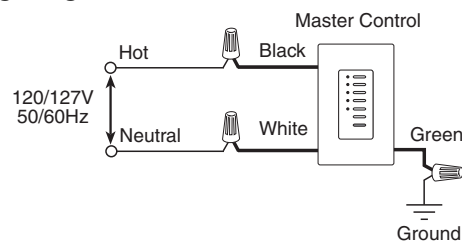

**Step 3** Attach wallplate adapter. Mount and align control. Snap on Claro® wallplate (purchased separately).

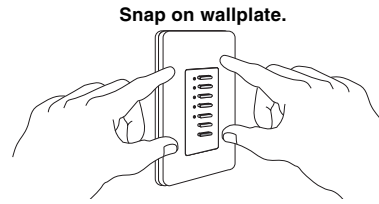
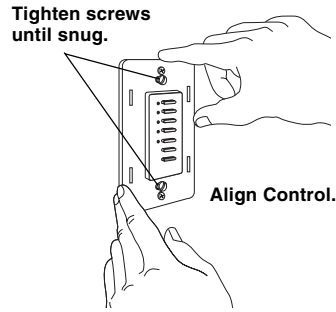

**Step 4** Turn power ON.

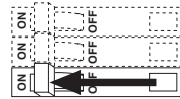

# Operation of the Master Control

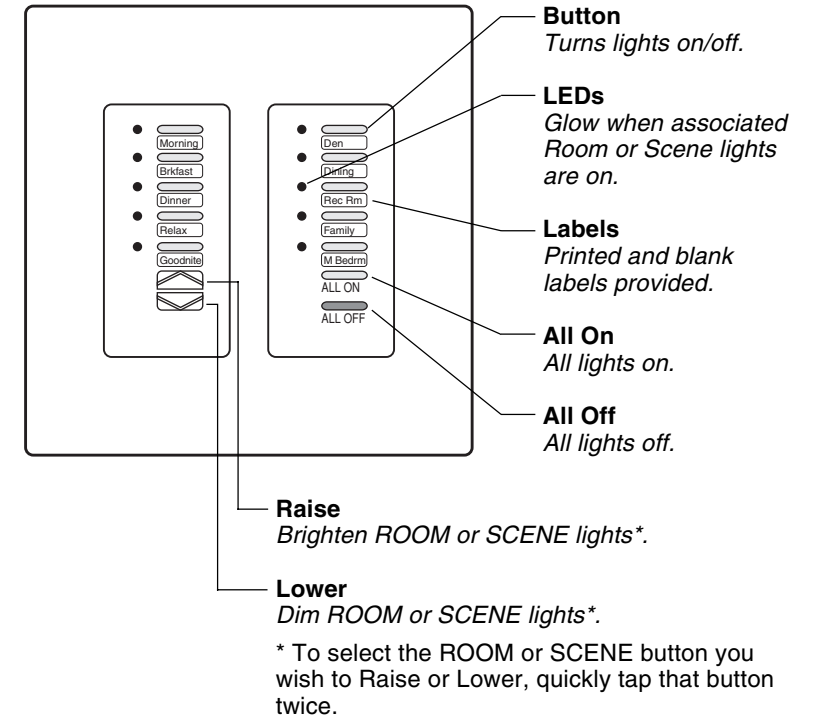

**NOTE:** Master Controls will not operate until they have been programmed.

**For detailed instructions on programming your Master Control, refer to the RadioRA® Setup Guide that is included with an RF Signal Repeater.**