

# RadioRA3

P/N 044417 Rev A

English

## Lamp Dimmer

RR3K-P20-240  
220-240 V~ 50/60 Hz

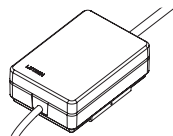

150 W or 1 A Max.  
LED\*

1 A 200 W  
Incandescent/  
Halogen

**Load Type:** The lamp dimmer is designed to dim one LED, incandescent, or tungsten halogen table or floor lamp. Use with LAMPS ONLY. It is recommended to plug the lamp directly into the dimmer receptacle and not through a multi-plug adaptor, power strip, or extension cord. Do not use to control a lamp that contains an integral dimmer or a touch lamp. For a lamp with an integral 3-way switch, the switch should be set to full on position. The lamp dimmer is compatible with trailing-edge loads. Not rated for magnetic low-voltage loads.

\* **LED Load Capacity:** LED current ratings must be below 1 A. If no current rating is available, wattage must be below 150 W.

**If using LED bulbs, we recommend that they are Lutron compatible.**

For the list of compatible LED bulbs, please visit [www.lutron.com/LEDtool](http://www.lutron.com/LEDtool)

For advanced features, tips for using LEDs, the complete RadioRA 3 product line, and more, please visit [www.lutron.com](http://www.lutron.com)

## Help

Europe: +44.(0)20.7702.0657

Asia: +91.124.439.0130

U.S.A./Canada: 1.844.LUTRON1

Mexico: +1.888.235.2910

Others: +1.610.282.3800

Fax: +1.610.282.6311

### Limited Warranty:

[www.lutron.com/europe/Service-Support/Pages/Service/Warranty](http://www.lutron.com/europe/Service-Support/Pages/Service/Warranty)

© 2024 Lutron Electronics Co., Inc.

The Lutron logo, Lutron, Pico, Radio Powr Savr and RadioRA 3 are trademarks or registered trademarks of Lutron Electronics Co., Inc. in the US and/or other countries.

Apple is a trademark of Apple Inc., registered in the U.S. and other countries. App Store is a service mark of Apple Inc.



## Installing the lamp dimmer

### 1 Turn the lamp ON and unplug the cord from the wall outlet

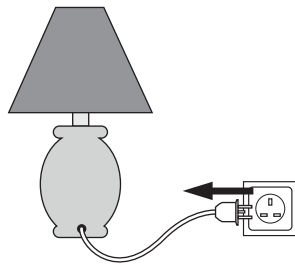

**WARNING - Electric Shock Hazard -**  
To avoid the risk of electrical shock, do not open, cut cord, or rewire the lamp dimmer. Modification of the module can result in personal injury or death.

**WARNING - Electric Shock Hazard -**  
To avoid the risk of electrical shock, unplug the lamp dimmer when changing light bulbs. Changing light bulbs with the power on could result in personal injury or death.

### 2 Plug the lamp cord into the lamp dimmer receptacle

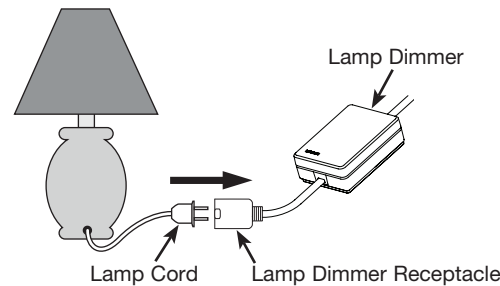

### 3 Insert the plug of the lamp dimmer into the wall outlet

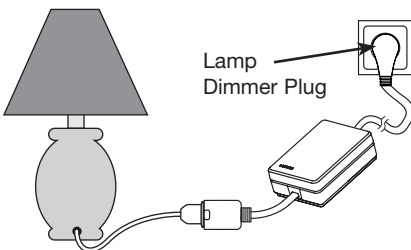

### 4 Turn the lamp dimmer ON using the toggle button

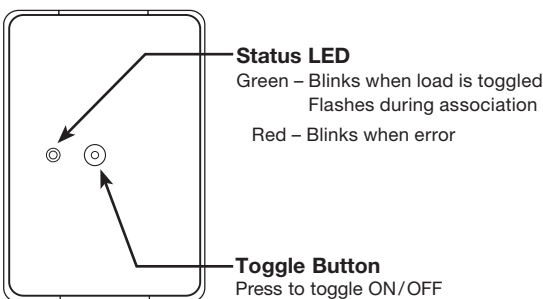

## Using the RadioRA 3 system

- RadioRA 3 processor (RRKE-PROC3-XX) is required for load control to work in a RadioRA 3 system.
- System programming and activation (addressing) must be done through the RadioRA 3 software.

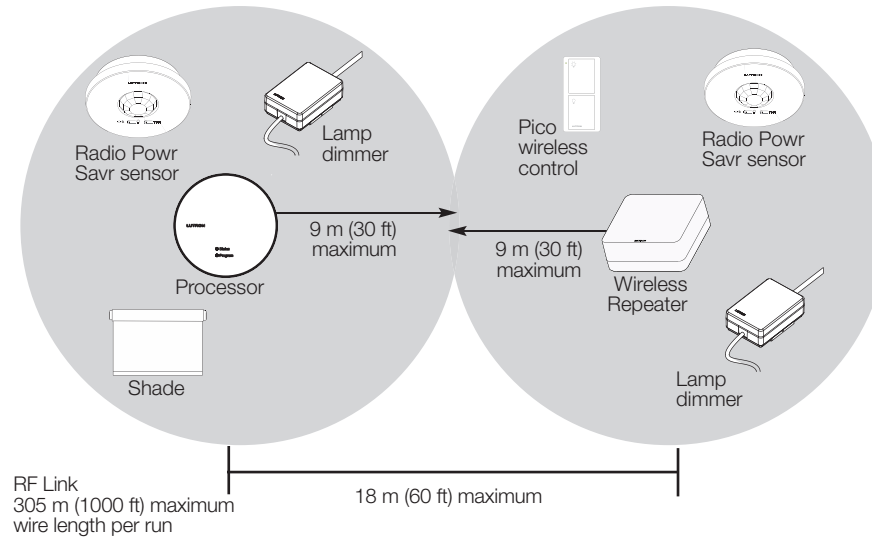

## Pairing the lamp dimmer and Pico wireless control without a system

### 1 Press and hold the button on lamp dimmer

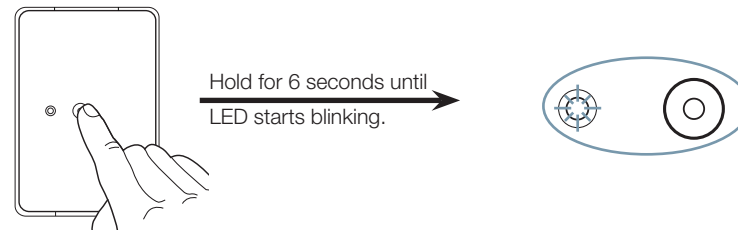

### 2 Press and hold the "off" button on Pico wireless control

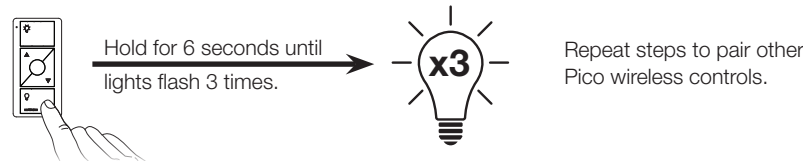

### 3 Set the light level on the Pico wireless control

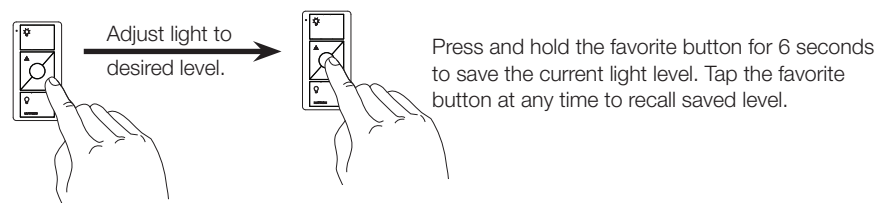

**TRA**  
**REGISTERED NO:**  
**ER89916/20**  
**DEALER NO:**  
**0016561/08**

## Error Codes - Red

Blink pattern * = on - = off	Probable Cause
* _____ *	• Product may be permanently damaged.
*_* _____ *	• Unsupported bulb type (dimmer not rated for magnetic low-voltage loads).
*_*_* _ *_*_* _	• Lamp may be shorted. • Circuit has too much load.
*_*_*_* _ *_*_*_* _	• Circuit has too much load. • Inadequate ventilation around lamp dimmer.

## IMPORTANT NOTES

**WARNING - Entrapment Hazard -** To avoid the risk of entrapment, serious injury, or death, these controls must not be used to control equipment which is not visible from every control location or which could create hazardous situations such as entrapment if operated accidentally. Examples of such equipment which must not be operated by these controls include (but are not limited to) motorized gates, garage doors, industrial doors, microwave ovens, heating pads, etc. It is the installer's responsibility to ensure that the equipment being controlled is visible from every control location and that only suitable equipment is connected to these controls. Failure to do so could result in serious injury or death.

**Environment:** Ambient operating temperature: 0 °C to 40 °C (32 °F to 104 °F), 0% to 90% humidity, non-condensing. Indoor use only.

**Cleaning:** To clean, wipe with a clean damp cloth. DO NOT use any chemical cleaning solutions.

**RF Device Placement:** Lamp dimmer must be located within 9 m (30 ft) of an RF signal repeater.

Hereby, Lutron Electronics Co. Inc., declares that the radio equipment type RR3K-P20-240 is in compliance with Directive 2014/53/EU. The full text of the EU declaration of conformity is available at the following internet address: [Lutron.com/cedoc](http://Lutron.com/cedoc)

## Troubleshooting

Symptoms	Probable cause
Lamp does not turn on.	<ul style="list-style-type: none"> <li>• Light bulb(s) burned out.</li> <li>• Breaker is OFF or tripped.</li> <li>• Light not properly installed.</li> <li>• The switch on the lamp has been turned off.</li> <li>• Error has occurred. See <b>Error Codes</b> section for more information.</li> </ul>
Lamp does not respond to Pico wireless control.	<ul style="list-style-type: none"> <li>• System devices are too far apart. A Lutron wireless repeater may be needed to extend the wireless range.</li> <li>• The lamp dimmer is already at the light level the Pico wireless control is sending.</li> <li>• The Pico wireless control is outside the 9 m (30 ft) operating range.</li> <li>• The Pico wireless control battery is low.</li> <li>• The Pico wireless control battery is installed incorrectly.</li> <li>• The switch on the lamp has been turned off.</li> <li>• Error has occurred. See <b>Error Codes</b> section for more information.</li> </ul>
<ul style="list-style-type: none"> <li>• Bulbs turn off while being dimmed.</li> <li>• Bulbs turn on at high light level but do not turn on at a low light level.</li> <li>• Bulbs flicker or flash when dimmed to a low light level.</li> </ul>	<ul style="list-style-type: none"> <li>• Verify LED bulbs are marked dimmable. Visit <a href="http://www.lutron.com/LEDtool">www.lutron.com/LEDtool</a> for a list of recommended LED bulbs.</li> <li>• Low-end trim may need to be adjusted for best LED bulb performance. Trim can be adjusted in the Lutron app.</li> </ul>

## Return to factory settings

1. Quickly triple tap the toggle button on the lamp dimmer, holding on the third tap.
2. Once the bulb starts to flash, release the toggle button and immediately triple tap it again.
3. The bulb will flash and the lamp dimmer will be returned to its factory settings.