

Caséta Smart Honeycomb Shades

English

Mounting and Setup Guide for Remote-Controlled, Insulating Honeycomb Shades. Please read before installing.

1 Prepare to Install

⚠ WARNING: RISK OF FIRE. Use only lithium batteries recognized by UL or other applicable local government safety agencies. DO NOT install backwards. Defective or improperly installed lithium batteries can cause fire resulting in serious injury or death.

⚠ CAUTION: RISK OF FALLING OBJECTS. Securely install the shade system per the mounting instructions. Mounting screws must drive into solid structural material. Add secure blocking if necessary. Use fasteners that are appropriate for the mounting surface. Shades wider than 48 in (1219 mm) must be handled and installed by at least 2 people. Failure to follow these instructions may result in minor or moderate injury.

1.1 Unpack the box and verify contents



Caséta Smart Honeycomb Shade



Mounting Brackets
quantity varies with shade size



Mounting Screws
2 per mounting bracket



Spacers (optional)
1 per mounting bracket

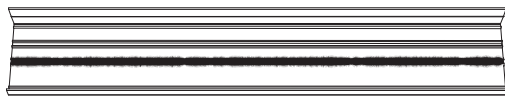

Back Cover with Wool Pile Strip



Command[™] Adhesive Strips
size and quantity may vary

1.2 Other items you will need:

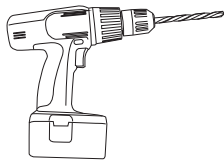

Drill with 3/32 in (2.4 mm) drill bit



#2 Phillips screwdriver



Pencil



Tape measure

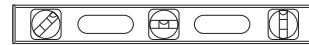

Level

Battery-powered shades:



(8) 1.5 V Lithium AA batteries
available separately

OR



1.5 V D-Cell
Alkaline Batteries
(4, 6, or 8 depending on shade size)
available separately

To achieve advertised battery life, please visit
lutron.com/optimizing-battery-life

1.3 Verify Correct Size

Hold the Back Cover up to the window to make sure it fits inside the window frame.

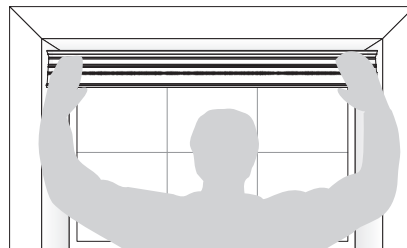

1.4 Apply the Adhesive Strips

Separate the adhesive strips, remove the red-printed backing, and apply them to the top or back surface of the Back Cover, evenly spaced. Press firmly.

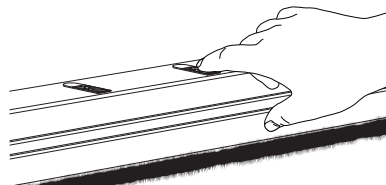

Caséta Smart Honeycomb Shades

2 Mount the Back Cover

2.1 Expose the Adhesive

Remove the black-printed liner from each adhesive strip applied in step 1.2.

2.2 Attach the Back Cover to the Window Frame

Press the Back Cover to the inside top window frame, ensuring that it is straight and parallel to the front edge of the framing. Press firmly.

NOTE: The adhesive strips are intended to serve as a temporary means of fastening the cover to the window frame. For permanent mounting, the shade bracket screws must pass through the cover as shown in section 3.

3 Install the Shade

3.1 Mount the Brackets to the Back Cover

- Refer to System Mounting Options and Bracket Placement Guide to position the brackets on the mounting surface and mark hole locations for pre-drilling. There is a groove scored in the underside of the Back Cover to aid in pre-drilling and fastening.
- For outside mount, use a level to make sure the marks are aligned.
- Pre-drill holes for the screws. Repeat for all brackets.
- Mount the shade brackets in the Back Cover as shown, using the provided screws or other appropriate fasteners driven through the top of the cover.

NOTE: It is the responsibility of the installer to use fasteners of appropriate type and length, and ensure they are driven securely into solid structure. Add secure blocking if necessary.

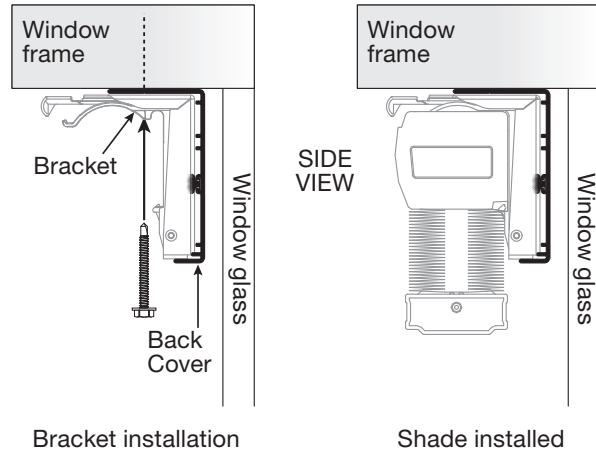

3.2 Hang the Shade in the Brackets

- Remove the yellow bracket locating labels from the headrail, if applicable.

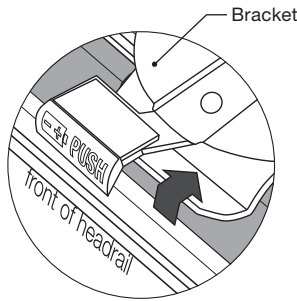

- Holding the shade in both hands, tilt the top of the shade slightly toward the window and hook the front edge of the headrail into the brackets behind the battery release tabs (➡ PUSH).

Headrail end cap omitted for clarity

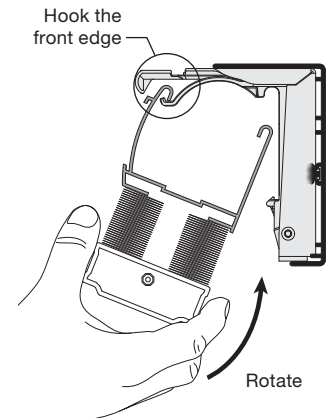

- Then rotate the back of the headrail up and press the bottom of the headrail firmly until you hear it **CLICK** into place. Verify that the headrail is fully engaged in all the brackets.

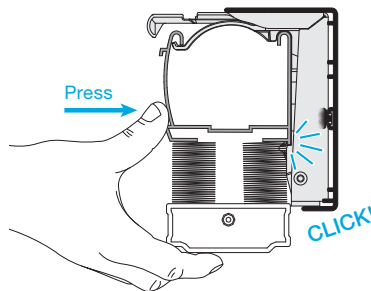

IMPORTANT: Ensure no fabric cells are caught in the brackets.

3 Install the Shade (continued)

System Mounting Options

Inside Mount

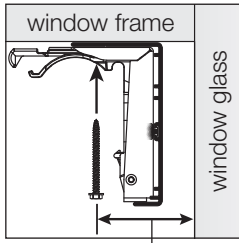

1.25 in (32 mm) minimum

(Type 1 Shades with external battery box only)

Outside Mount On Trim

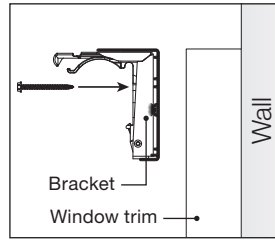

Outside Mount Above Trim

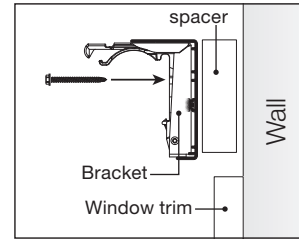

If the window trim protrudes, install a spacer (included) behind each bracket.

3 Install the Shade (continued)

Bracket Placement Guide

Key: 1 Shade Bracket 2 Spool 3 Electronic Drive Unit (EDU)

Type 1 Shades: (2) spools and (8) AA Lithium batteries (2 brackets)

- A bracket 1 should be mounted directly above each spool 2.

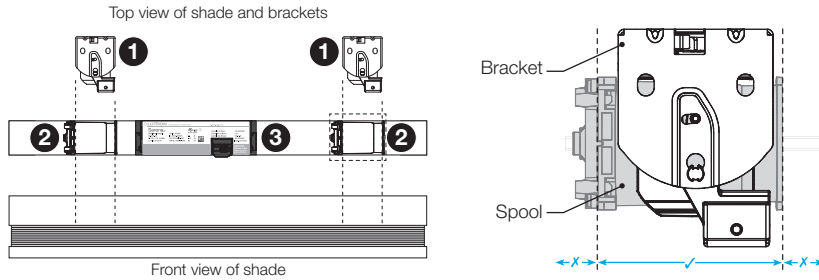

Type 2 Shades: (2) spools and D-size Alkaline batteries (2 brackets)

- Position each bracket 1 2 in (51 mm) from each end of the shade, above the outer battery box position. This ensures adequate battery installation/change clearance after the shade is installed.

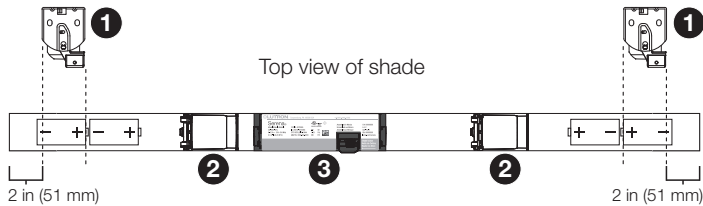

Type 3 Shades: (3) spools and D-size Alkaline batteries (3 brackets)

- Position each outer bracket 1a 2 in (51 mm) from each end of the shade, above the outer battery box position. This ensures adequate battery installation/change clearance after the shade is installed.
- Position the center bracket 1b 2 in (51 mm) to the left of the center spool 2.

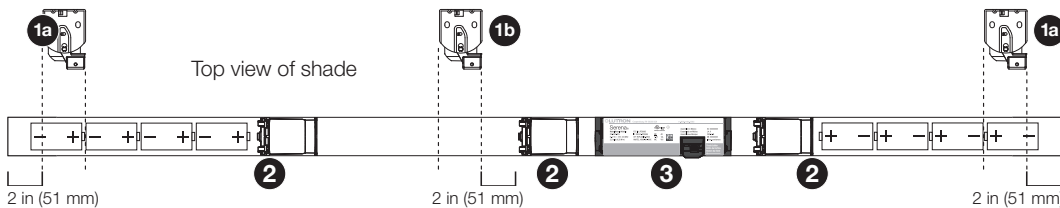

Type 4 Shades: (4) spools and D-size Alkaline batteries (4 brackets)

- Position each outer bracket 1a 2 in (51 mm) from each end of the shade, above the outer battery box position. This ensures adequate battery installation/change clearance after the shade is installed.
- Position the inner brackets 1b centered on marks measured at 1/3 of the shade width from each end.

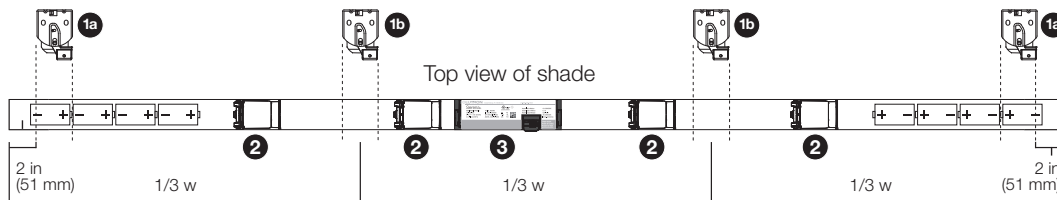

4 Install the Batteries

4.1 Expose the Top of the Headrail

Press ALL the bracket release tabs ( PUSH) above the headrail. The shade will tilt forward.

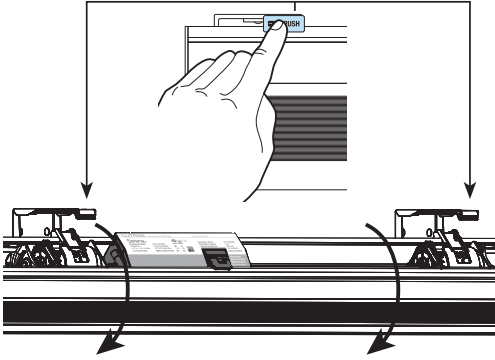

4.2 Install the Batteries

Install the batteries only as indicated in the battery holders. The Shade Button (see section 4) will blink red/green 3 times when the shade is powered. If the batteries are not inserted correctly, the shade may not power up.

For best battery life:

DO NOT mix old and new batteries, install carbon-zinc or rechargeable batteries, or mix battery types.

ONLY USE matching 1.5 V alkaline D size batteries

⚠ WARNING: RISK OF FIRE. Improperly installed lithium batteries can cause fire resulting in serious injury or death. DO NOT install backwards. Use only lithium batteries safety recognized by UL or other applicable local government safety agencies.

4.3 Return to Operating Position

Tilt the shade back into the brackets; pressing gently until you hear a “click” at each bracket.

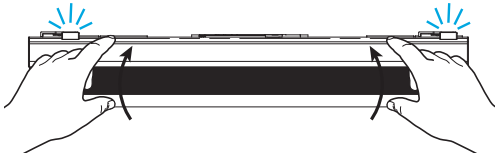

5 Setup and Programming

5.1 Determine Control Intent

The shade features a single LED-equipped control button (the 'Shade Button'), located on the Electronic Drive Unit (EDU), in the headrail near the center of the shade. The Shade Button is used to activate and indicate various steps while assigning and programming the shade for compatible handheld or system-based remote control.

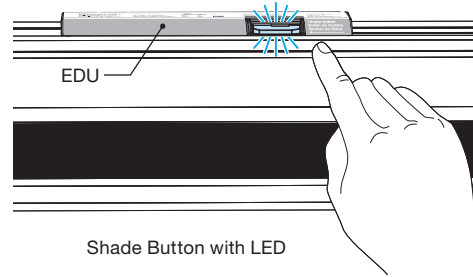

NOTE: When changing from one type of control assignment to another, such as upgrading from a standalone Pico control to a Caséta Smart Bridge, the shade must be restored to its factory default settings. Refer to **Restoring Factory Default Settings** in the **Troubleshooting** section.

- If a Caséta Smart Bridge is installed, use the Lutron App to program and control the shade.
- For non-system applications, follow the steps in section 4.2 to assign a Pico remote control. Repeat the sequence for each additional shade or assignment, if applicable.

5.2 Assign a Pico Wireless Control

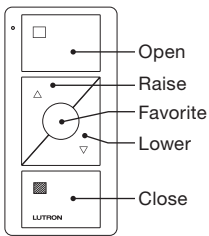

a. Tap the Shade button



b. The Shade Button lights green

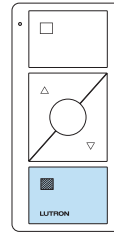

c. Press and hold the Close button

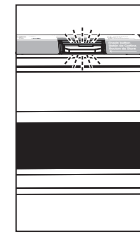

d. The Shade Button flashes green; assignment is complete

5 Setup and Programming (continued)

5.3 Adjust Upper and Lower Limits (Optional)

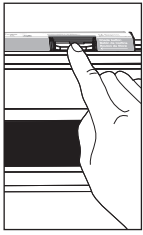

a. Tap the Shade button



b. The Shade Button lights green

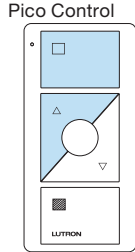

c. Press and hold the Open and Raise buttons simultaneously

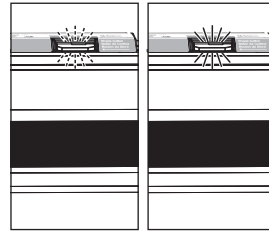

d. The Shade Button flashes green, then stays lighted; release all buttons

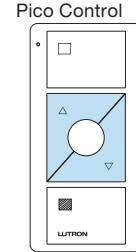

e. Use the Raise and Lower buttons to position the shade as desired

IMPORTANT: When raising the shade to its highest position, and when setting the upper limit, the fabric cells should close and stack gently. Compressing the fabric tightly will cause undue wear on the shade's drive gear and shorten the battery life in battery powered shades.

f. SET THE UPPER LIMIT
With the shade at the desired open position, press and hold the Open button

OR SET THE LOWER LIMIT
With the shade at the desired closed position, press and hold the Close button

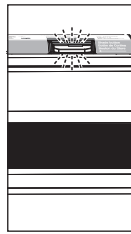

g. The Shade Button flashes green; adjustment is complete

5.4 Set a Favorite Shade Position (Optional)

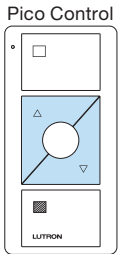

a. Use the Raise/Lower buttons to move the shade to the desired position.

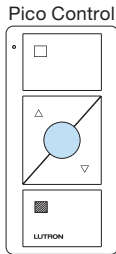

b. Press and hold the Favorite button for 6 seconds.



c. The Shade Button flashes green; the Favorite position is saved

Removing the Shade from the Brackets

Bracket (front view, no shade)

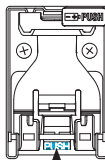

Release Tab

Each bracket includes a release tab at the bottom-center. When pushed, the bracket releases the back of the headrail.

With the shade fully raised, support it with one hand while using a finger of the other hand to press the release tab. Repeat for each bracket on the shade.

After the shade is released from all brackets, lift the shade off the brackets.

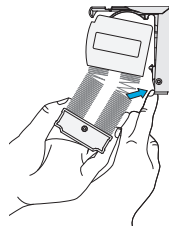

Press the release tab (side view)

Troubleshooting

Problem	Solution
The shade does not power up when batteries are inserted	<ul style="list-style-type: none"> • Verify all batteries are new and of the correct type • Remove all batteries and reinstall, ensuring they are oriented correctly
Battery power only	<ul style="list-style-type: none"> • Battery power only
The shade does not respond to remote control	<ul style="list-style-type: none"> • Ensure the remote control is within the product's RF range; 30 ft (9 m) • If a Caséta system is installed, ensure the remote control is assigned in the app
Shade motion is sluggish and/or the shade button LED is RED	<ul style="list-style-type: none"> • The batteries are low; remove all batteries and replace with new ones, ensuring they are oriented correctly
The shade does not respond and the shade button LED is flashing or constant RED	<ul style="list-style-type: none"> • The batteries are dead; remove all batteries and replace with new ones, ensuring they are oriented correctly
After installing new batteries, the shade does not respond	<ul style="list-style-type: none"> • Press and release the shade button once to resume normal operation
The batteries are fresh, but the shade button LED flashes RED	<ul style="list-style-type: none"> • An obstacle is preventing the shade from moving to the desired position or preset • If this condition occurs while setting the upper limit (section 4.4), the fabric cells may be stacked too tightly — lower the shade slightly, then save the new upper limit position
The bottom bar is not level	<ul style="list-style-type: none"> • Verify the headrail is level • Verify the lift spools are fully seated in the headrail • Leave the shade lowered and allow up to 24 hours for the fabric to relax. • Gently pull down on the bottom bar as the shade approaches lower limit
There is a problem not listed here	<ul style="list-style-type: none"> • Contact Lutron Technical Support

Restoring Factory Default Settings

Tap the shade button quickly three times, and hold the shade button after the third tap until the shade button LED flashes GREEN rapidly.

Immediately tap the shade button quickly three more times, until the shade button LED flashes GREEN rapidly, then flashes RED/GREEN three times, and turns off.

Models:

CS-EDU3-SYJ	6-12 V ⁼⁼⁼	5 W	2,5 in-lb (0,28 N*m)
-------------	-----------------------	-----	----------------------

FCC Information

NOTE: This equipment has been tested and found to comply with the limits for a Class B digital device, pursuant to part 15 of the FCC rules. These limits are designed to provide reasonable protection against harmful interference in a residential installation. This equipment generates, uses and can radiate radio frequency energy and, if not installed and used in accordance with the instructions, may cause harmful interference to radio and television reception, which can be determined by turning the equipment off and on. The user is encouraged to try to correct the interference by one or more of the following measures:

- Reorient or relocate the receiving antenna.
- Increase the separation between the equipment and receiver.
- Connect the equipment into an outlet on a circuit different from that to which the receiver is connected.
- Consult the dealer or an experienced radio/TV technician for help.

Caution: Changes or modifications not expressly approved by Lutron Electronics Co. could void the user's authority to operate this equipment.

This device complies with Part 15 of the FCC Rules. Operation is subject to the following two conditions:

- (1) This device may not cause harmful interference, and
- (2) This device must accept any interference received, including interference that may cause undesired operation. This Class B digital apparatus complies with Canadian ICES-003.

IC Information

This device complies with Industry Canada licence-exempt RSS standard(s). Operation is subject to the following two conditions:

- (1) This device may not cause harmful interference, and
- (2) This device must accept any interference received, including interference that may cause undesired operation of the device.

USA

Lutron Electronics Co., Inc.
7200 Suter Road,
Coopersburg, PA 18036
lutron.com/help
support@lutron.com
1.844.LUTRON1 (588-7661)

EEA

Lutron NL B.V.
PO Box 15862, 1001 NJ
Amsterdam, Netherlands (Importer)

United Kingdom

Lutron EA Ltd.
3rd Floor, 51 Lime Street
London, EC3M 7DQ
England (Importer)
Tel: +44.(0)20.7680.4481
Fax: +44.(0)20.7480.6899
Freephone: 0800.282.107

For complete warranty information, refer to:
[lutron.com/TechnicalDocumentLibrary/Window Systems Warranty.pdf](http://lutron.com/TechnicalDocumentLibrary/Window_Systems_Warranty.pdf)

Lutron, the Lutron logo, and Caséta are trademarks or registered trademarks of Lutron Electronics Co. Inc., in the U.S. and/or other countries.
All other product names, logos, and brands are property of their respective owners.