

Overview

Use this document as a reference when considering a Palladiom Wire-Free Shade for mounting on or above a door. While it might seem logical to specify Wall Mount brackets for door applications, Lutron offers a Ceiling/Door bracket to be used instead of a Wall Mount bracket, even though the bracket will be mounted on a vertical surface.

Because the Slide Ring of the Palladiom Ceiling/Door bracket moves *vertically* when in door-mount orientation, potential for the shade disengaging from the bracket during occupants' routine use of the door is greatly reduced.

It is also important to understand aesthetic and clearance considerations when using the Ceiling/Door bracket in on-door and above-the-door applications. This document will highlight those aspects and as other important items to consider when mounting a shade on or above a door using Ceiling/Door brackets.

Door-mount options are available as specific choices in myProjects, ensuring the appropriate Ceiling/Door bracket(s) are selected automatically.

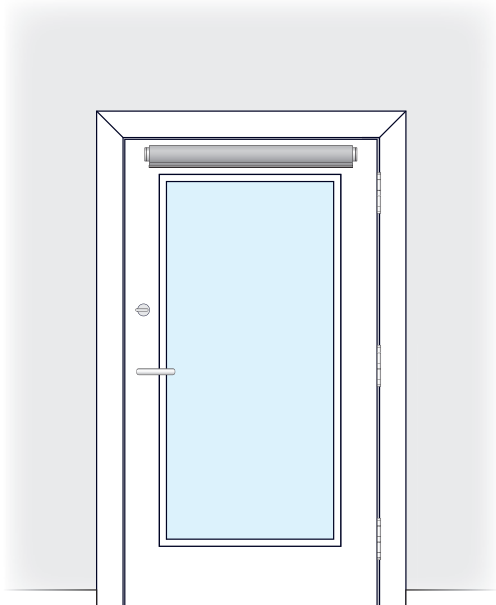

On the Door

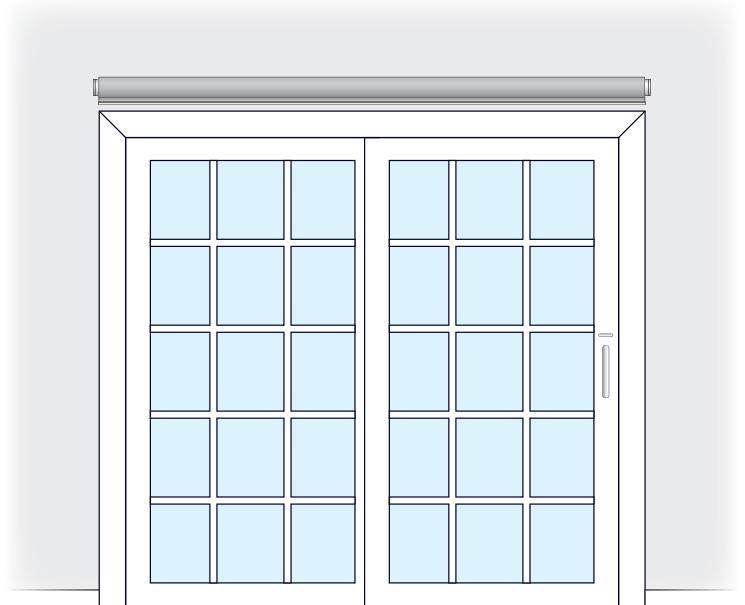

Above the Door

The Palladiom Ceiling/Door Bracket Mounted On or Above the Door

Benefits

Utilizing a Ceiling/Door bracket prevents inadvertent extension of Bracket Slide Ring and improves mounting stability because with a Ceiling/Door bracket in door-mount orientation, the Slide Ring moves vertically as opposed to the horizontal movement of a Wall Bracket.

A Wall Bracket Slide Ring moves horizontally

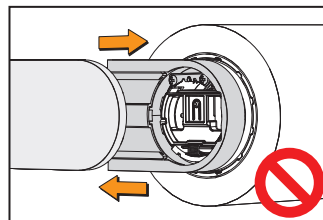

The Slide Ring of a Ceiling/Door bracket in door-mount orientation moves vertically

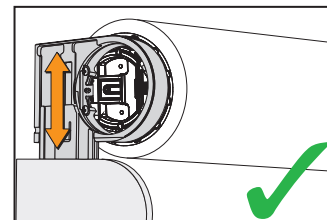

Vertical Slide Ring movement is safer and more stable when mounting on or above a door

On a Hinged Door:

- Prevents inadvertent extension of the Bracket Slide Ring due to door movement.
- Provides increased stability during battery changes.

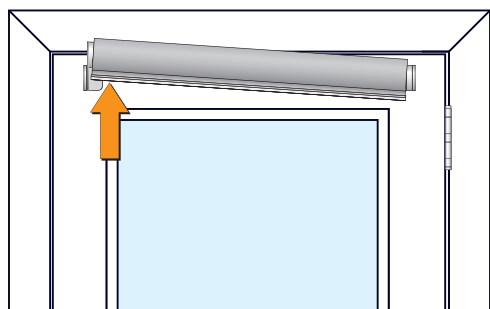

Above the Door:

- Prevents inadvertent extension of the Bracket Slide Ring should passage through the door be attempted while the shade is lowered.
- Provides increased mounting stability if the event the shade is manually pulled or pushed aside to access the door. *(It is recommended that the shade is always fully raised before the door is used for passage.)*

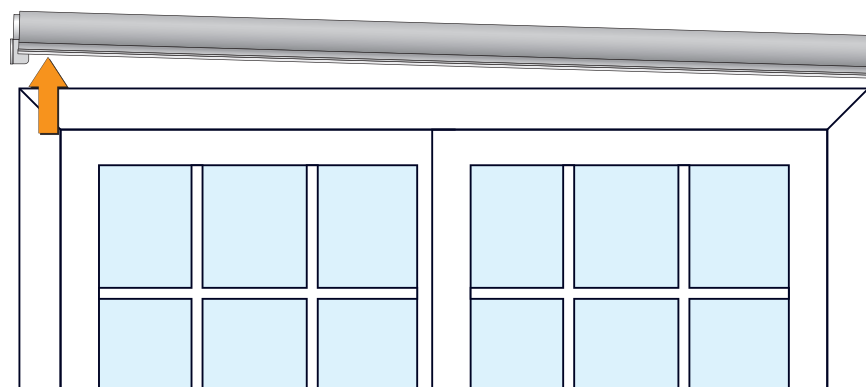

Maintain support of the operator end of shade during battery change to prevent injury or damage

Additional Considerations

- Allow six inches of clearance above the shade for battery access
- Always maintain support of the operator end of the shade during battery change to prevent injury or damage from the Bracket Slide Ring unexpectedly falling back into operating position
- When the Ceiling/Door operator bracket is mounted on a door, the edge of the bracket that would normally be hidden in ceiling-mount orientation is visible from below, revealing gaps between the slide ring channels and bracket tracks. This is most noticeable with lighter bracket finishes, and less pronounced in darker bracket finishes, as shown in the side-by-side comparison at right:

