

Sivoia QS | Roller 300 LIFT

The Sivoia QS Roller 300 LIFT system utilizes the precision controlled Electronic Drive Unit (EDU). The Sivoia QS EDU is housed inside the roller shade assembly and controls the movement of the shades, keeps track of the shades' position, and adjusts the shades to the user's desired preset positions.

Features

- Operation: will not exceed 50 dBA measured 3 ft (1 m) from the EDU
- Shades move in perfect unison and exact alignment within 0.125 in (3 mm) accuracy at all times
NOTE: This may not apply to shades with battens
- Smooth starts and stops
- Single Fabric Panel: Standard sizes available up to 12 ft (3.66 m) wide and up to 30 ft (9.1 m) tall
- Lutron Intelligent Facade Technology (LIFT) allows up to 6 coupled shade panels to be driven by a single EDU
- Maximum 300 sq ft of fabric at a linear speed of 3.6 inches/second
- Offers programmable stop points. The EDU tracks the position of the shade and is able to adjust it to predetermined locations at the touch of a button
- Provides maximum window coverage with the smallest possible light gaps, 0.75 in (19 mm) between the shade fabric and the window frame and 1.5 in (38 mm) between coupled shades.
- Light gaps are symmetrical on both sides of the fabric
- Does not require group controls or relay systems to create shade groups and sub-groups
- 35 V $\overline{=}$ low-voltage power
- Power failure memory for the lifetime of the product
- 8 year limited warranty
- At high aspect ratio (tall and narrow) shade sizes, Lutron may increase the size of the light gaps to compensate for the increased probability of telescoping.

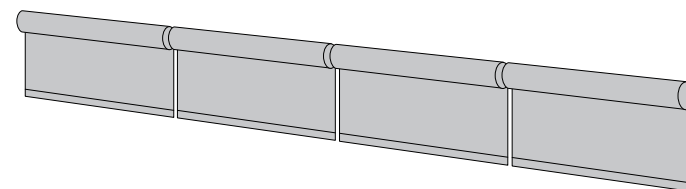

Sivoia QS Roller 300 LIFT
(In-Line Coupled mount shown)

NOTE: Clerestory shades are used in applications where the shade height is between 20 ft (6.1 m) and 30 ft (9.1 m). Clerestory shades are available as ceiling or pocket mount only. They are not available with coupling.

IMPORTANT: Lutron motorized shades must be mounted to blocking or other suitable structural material. It is the responsibility of the installer to choose and install fasteners that are appropriate for the mounting surface such that each shade bracket can support the shade load. Shade bracket loading requirements can be found in the applications section of this document. Clerestory bracket loading can be found in the Clerestory section of this document.

Job Name:

Model Numbers:

Job Number:

Specifications

Power

- Operating voltage: Low-voltage Class 2, 35 V $\overline{=}$ power supply required¹
- Control system power supply offers (spike and brownout) overvoltage protection (+/- 10% of line voltage) for all devices in the system
- Power supply provides appropriate Electro Static Discharge (ESD) protection for all devices in the system
- Power must be derived from a Lutron approved NEC® Class 2 powersource

Performance

- System allows for symmetrical light gaps as small as 0.75 in (19 mm) on each side
- Each EDU stores presets positioned at any stop point along the shade’s travel, as well as full open and full close shade limits
- Each EDU is capable of stopping with the accuracy of 0.125 in (3 mm) steps for the entire travel of the shade
- For systems with multiple EDUs, shades smoothly move in unison and exact alignment within 0.125 in (3 mm) accuracy at all times

NOTE: This may not apply to shades with battens

- Limits are programmable and adjustable from the EDUs and/or via Lutron controls

Controls and Integration

- Shades seamlessly integrate with Lutron lighting controls, enabling features such as shared lighting and shade keypads, scene control, timeclock automation, software and mobile application control, and solar adaptive automation
- Third-party integration available via contact closure, RS232 or Ethernet

Grouping

- System keypads can control any EDU, group, or subgroup without a separate group controller or additional interface²
- System groups and subgroups can be reconfigured at the point of control without rewiring and without access to the EDU²
- Controls within this system are able to operate any group or subgroup of EDUs, regardless of window treatment type²

¹ Refer to power supply spec for system compatibility

² May require a service visit from a Lutron Qualified Technician

Shade Options

Mounting Options

- Inside mount
- Outside mount

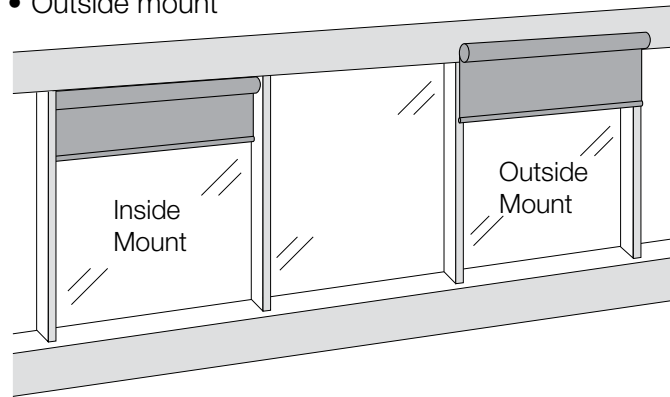

Drive Side Options

- Left
- Right

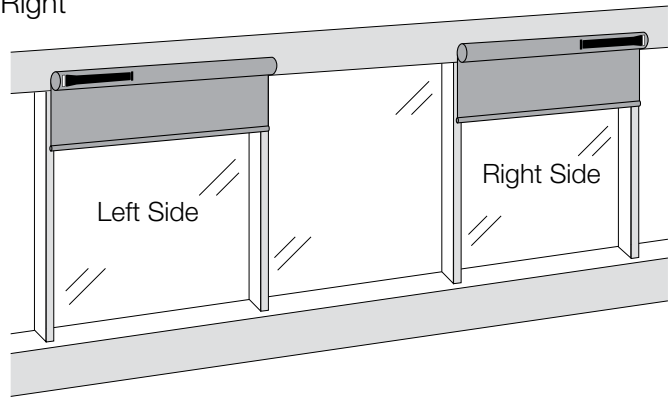

Fabric Drop Options

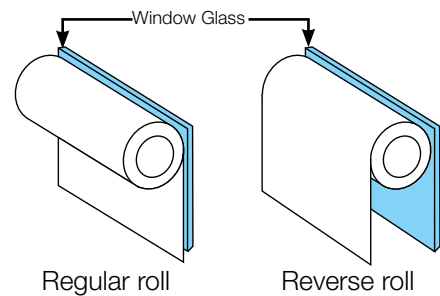

Hembar Options

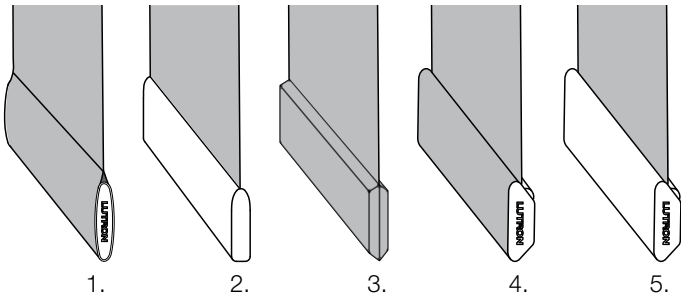

1. Designer (standard)
2. Exposed*
3. Sealed
4. Architectural Half-Wrap*
5. Architectural Exposed*

* Colors available: white, black, bronze, silver, or custom color

NOTE: Hembar option availability may be limited based on chosen fabric

Fabric Options

Available in a wide variety of fabric types including:

- **Sheer**
Filter sunlight, UV protection, view
 - **Privacy**
Minimal translucence, UV protection
 - **Blackout**
Room darkening, maximum UV protection, no view
- For complete fabric selection, visit lutron.com

Dimensions

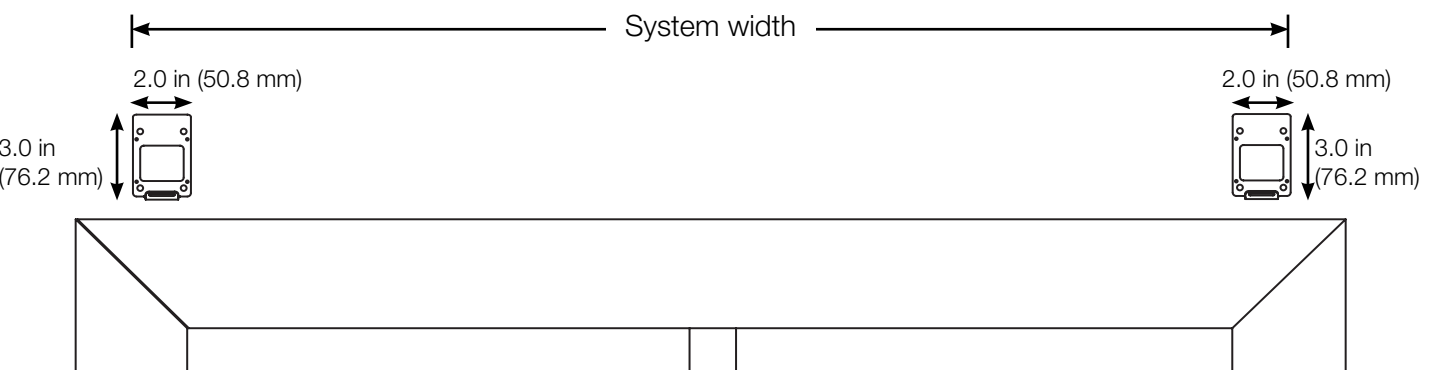

Complete Assembly

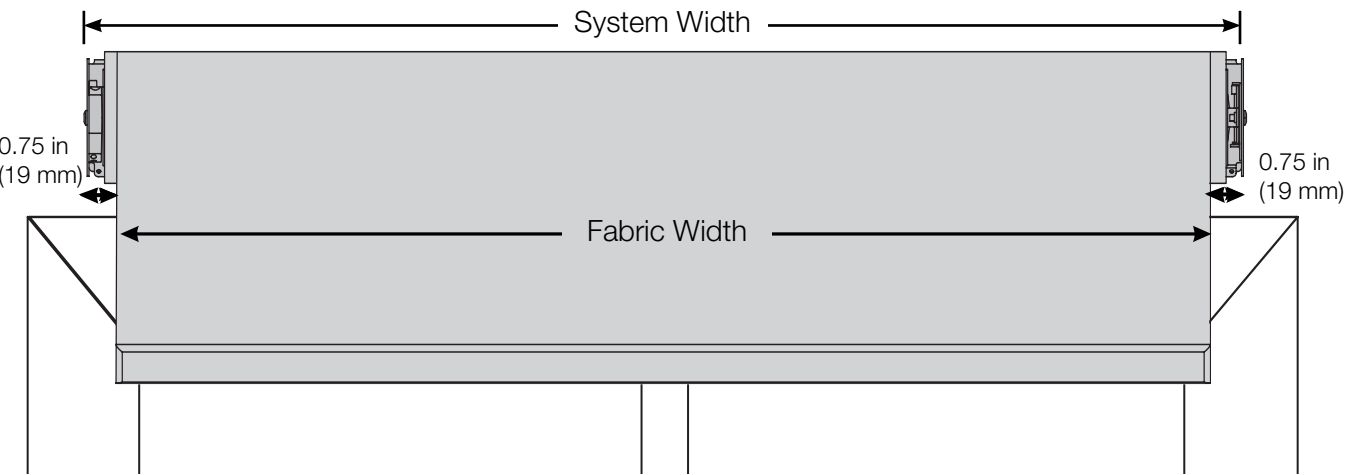

(Wall brackets shown)

Bracket Options

Sivoia QSRoller 300 brackets employ a two-piece design to maximize ease and flexibility of installation.

1) Wall Mount Bracket

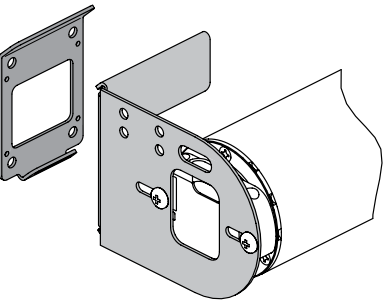

Wall brackets are designed to bear loads up to 250 lbs (133 kg) each.

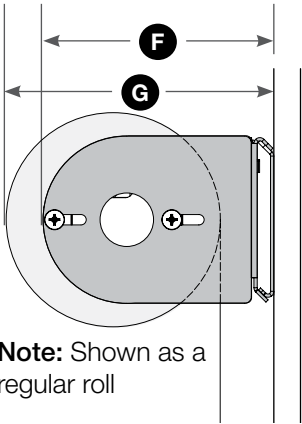

Note: Shown as a regular roll

Dimensions

- F** 4.3 in (109 mm)
- G** 5 in (127 mm)

2) Ceiling Mount Bracket

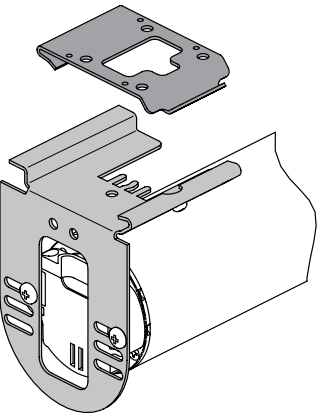

Ceiling brackets are designed to bear loads up to 250 lbs (133 kg) each.

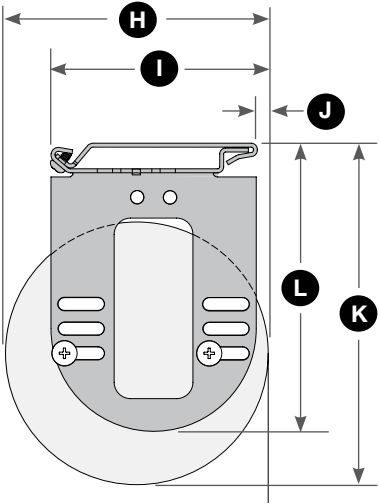

Dimensions

- H** 4 in (102 mm)
- I** 3.31 in (84 mm)
- J** 0.0165 in (4 mm)
- K** 5.2 in (132 mm)
- L** 4.39 in (111 mm)

3) Jamb Mount Bracket

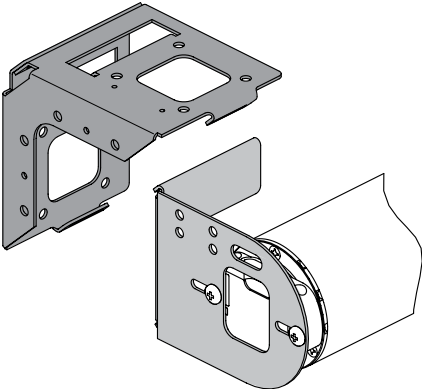

Jamb brackets are designed to bear loads up to 250 lbs (133 kg) each.

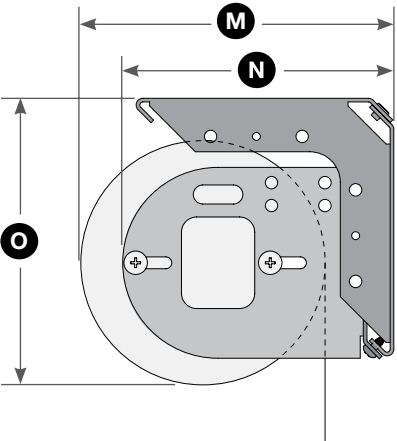

Dimensions

- M** 5.125 in (130 mm)
- N** 4.44 in (113 mm)
- O** 4.69 in (119 mm)

Job Name:	Model Numbers:
Job Number:	

Bracket Options (continued)

Sivoia QS Roller 300 brackets employ a two-piece design to maximize ease and flexibility of installation.

4) Dual Mount Bracket

A common roller shade application is the use of two fabrics on one window, typically a sheer and a blackout. Fabric unrolls closest to glass.

Dual mount brackets are designed to bear loads up to 250 lbs (133 kg) each.

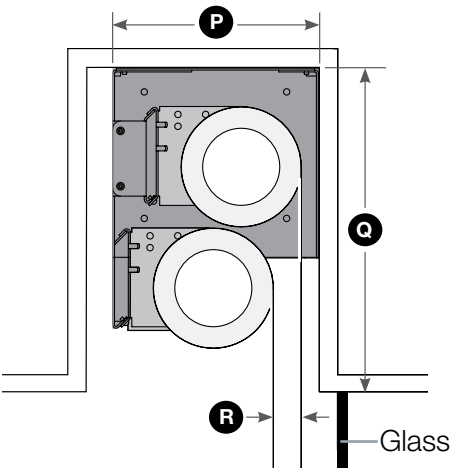

Dimensions

- P 7 in (178 mm)
- Q 11 in (279 mm)
- R 1 in (25 mm)

5) Fascia Mount Bracket

Fascia mount brackets are designed to bear loads up to 250 lbs (133 kg) each.

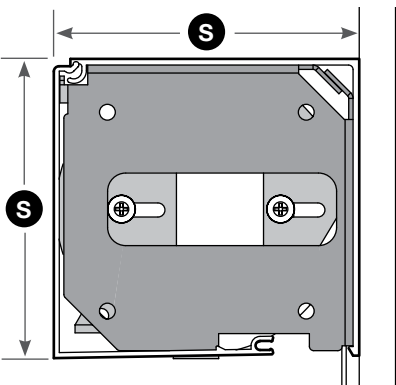

Dimensions

- S 4.2 in (107 mm)

6) Pocket Mount Bracket

Pocket mount brackets are designed to bear loads up to 250 lbs (133 kg) each.

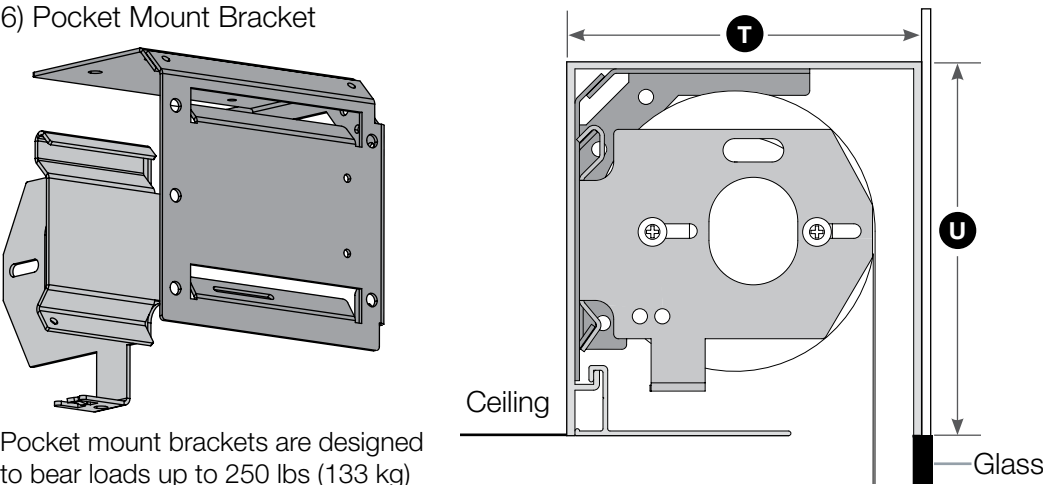

Dimensions

- T 4.75 in (121 mm)
- U 5 in (127 mm)

Inline Coupled System

Up to six shade panels can be coupled, powered by a single electronic drive unit (EDU).

- Increased efficiency by operating multiple shades with one EDU
 - 1.5 in (38 mm) minimum light gap between panels
 - Available with all mounting options
 - Hembars of coupled shades may be aligned after installation (see below)
 - The coupled system maintains precise hembar alignment (within 0.125 in [3 mm])
- NOTE:** This may not apply to shades with battens

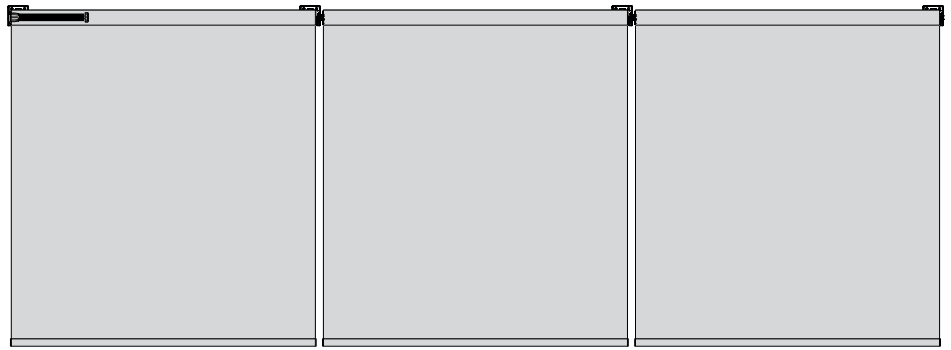

3-Panel Coupled System

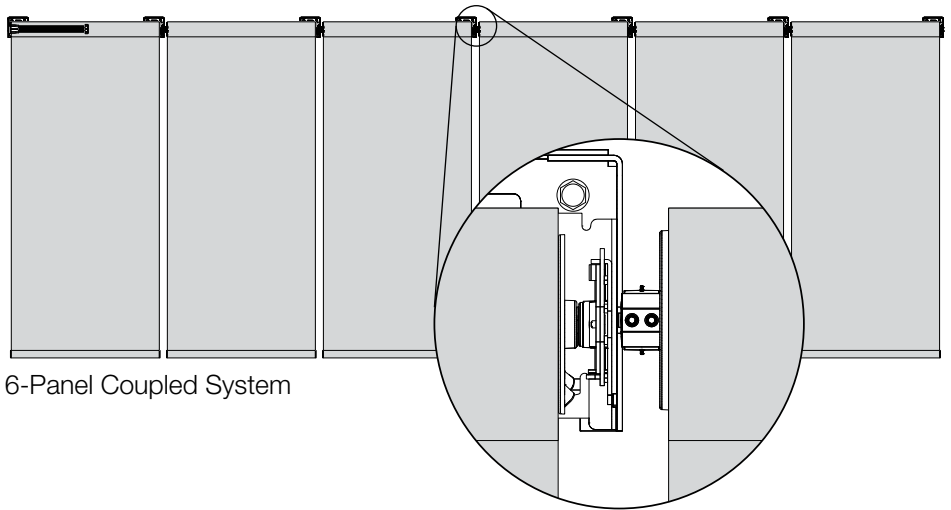

6-Panel Coupled System

Hembar Alignment

- Hembars of adjacent shades can be leveled during installation
- To level hembars – loosen both coupler hub set screws, adjust the shade and re-tighten both screws

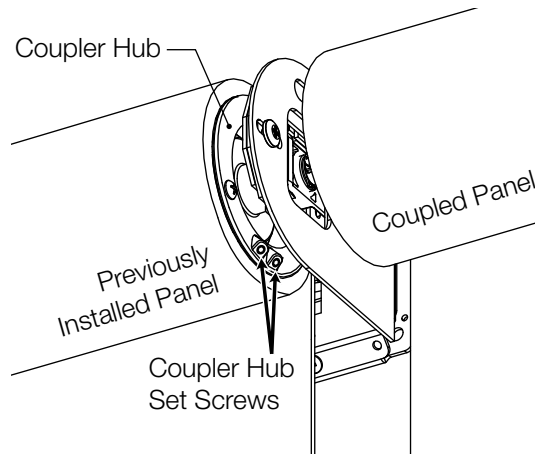

Clerestory Shades

The Lutron Clerestory shade is used in applications where the shade height is between 20 ft (6.1 m) and 30 ft (9.1 m). It is also required where there are multiple shades mounted in a multi-story application where the shade mounting height is above 20 ft (6.1 m).

Specifications

- Maximum height of 30 ft (9.1 m).
- Minimum recommended mounting space of 7 in (178 mm) x 7 in (178 mm).
- Ceiling and pocket mount only.
- Limited fabrics available.
- Battens are required on shades over 20 ft (6.1 m) in height.
- Side channel is not recommended for use in a Clerestory shade application.
- Not available with coupling.
- IHA is available.
- Available with cable guide for vertical applications.
- Custom options including shades taller than 30 ft (9.1 m), dual shades, smaller pockets, and wall mount may be available. Contact Lutron for more information.

Mounting Options for Clerestory Shades

Bracket Mount

- Clerestory brackets are designed to bear loads up to 1000 lbs (454 kg) each.

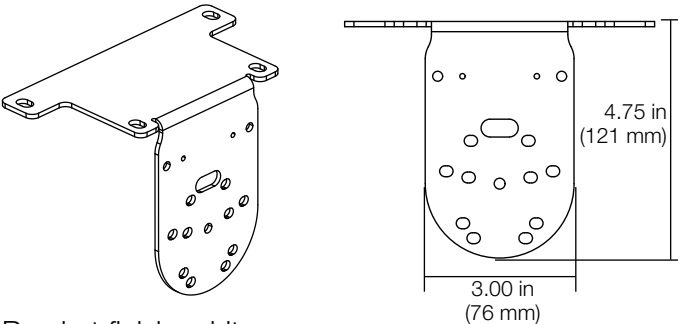

Bracket finish: white

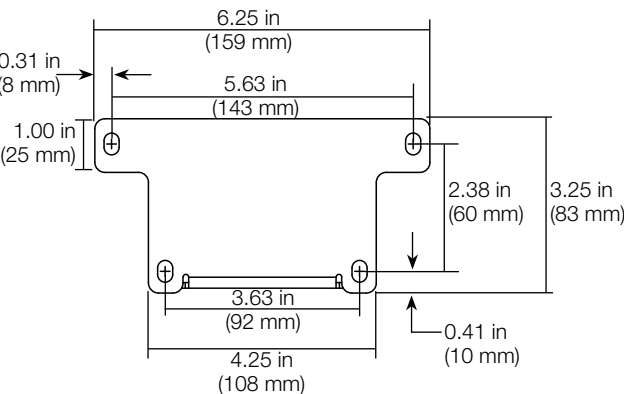

Pocket Mount

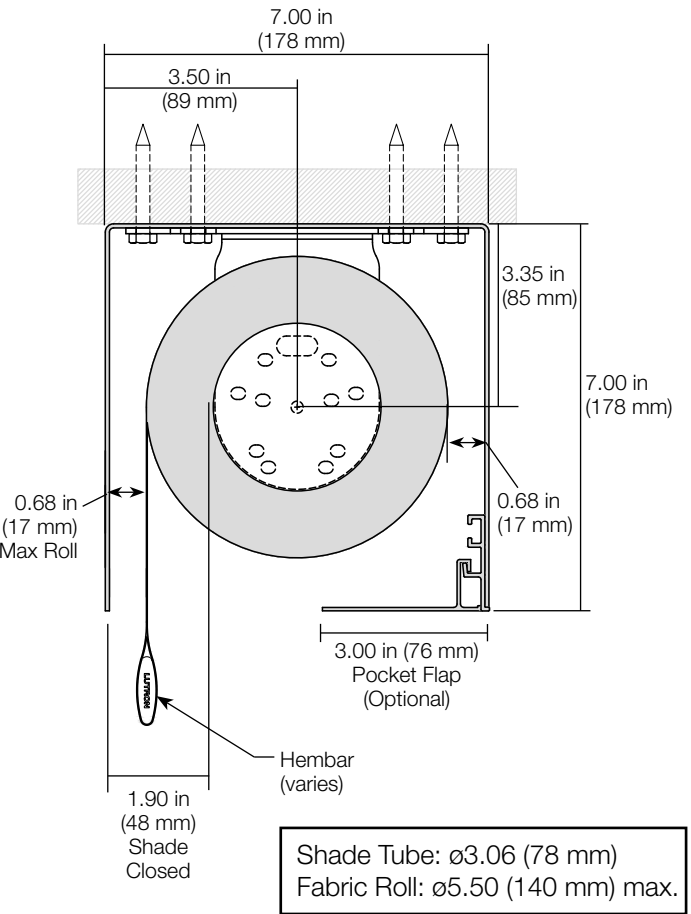

Clerestory Shades (*continued*)

Applications for Clerestory Shades

Shade mounting height is between 20 ft (6.1 m) and 30 ft (9.1 m).

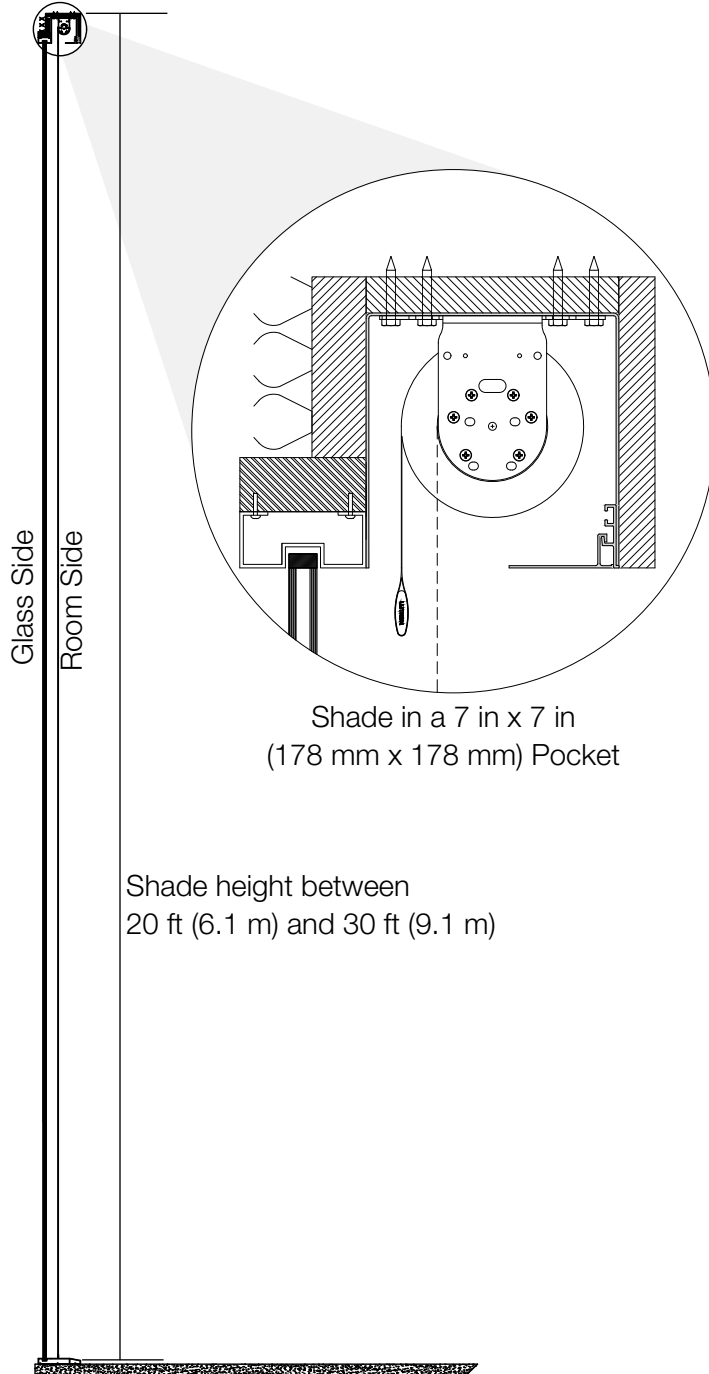

Shade mounted in a multi-story application where mounting height is above 20 ft (6.1 m).

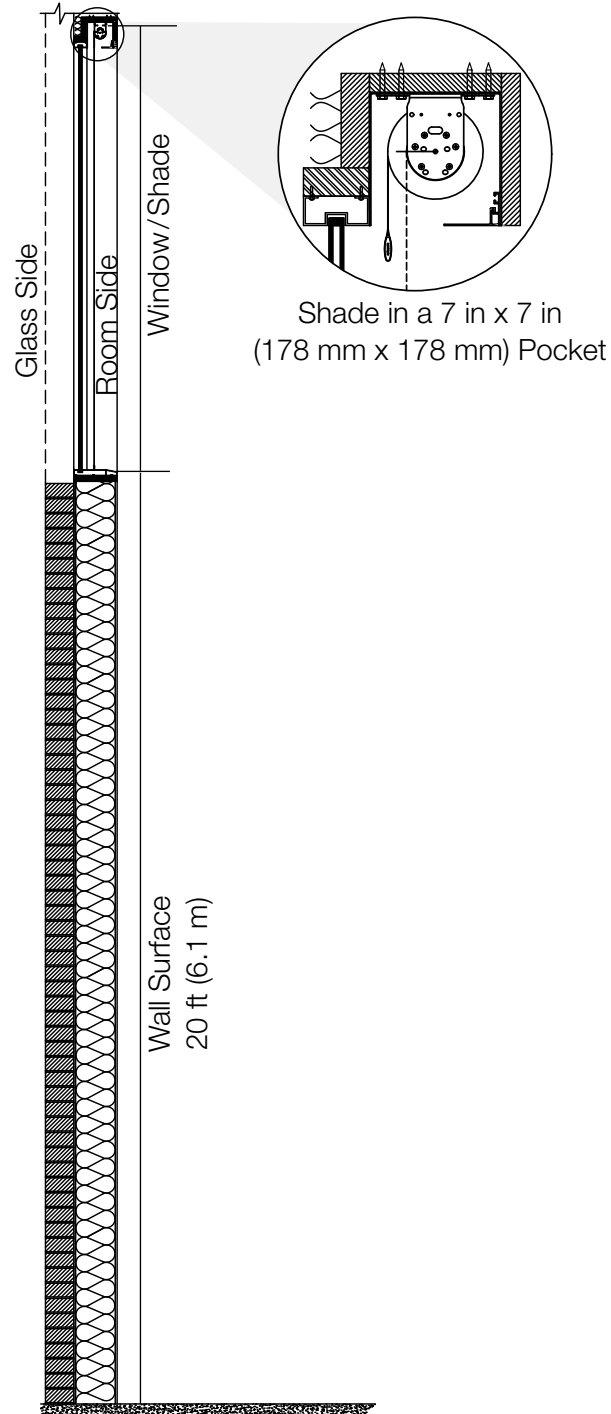

Job Name:

Model Numbers:

Job Number:

Clerestory Shades (continued)

Batten Rules for Clerestory Shades

Shade heights of 20 ft (6.1 m) to 25 ft (7.6 m) require one (1) batten.

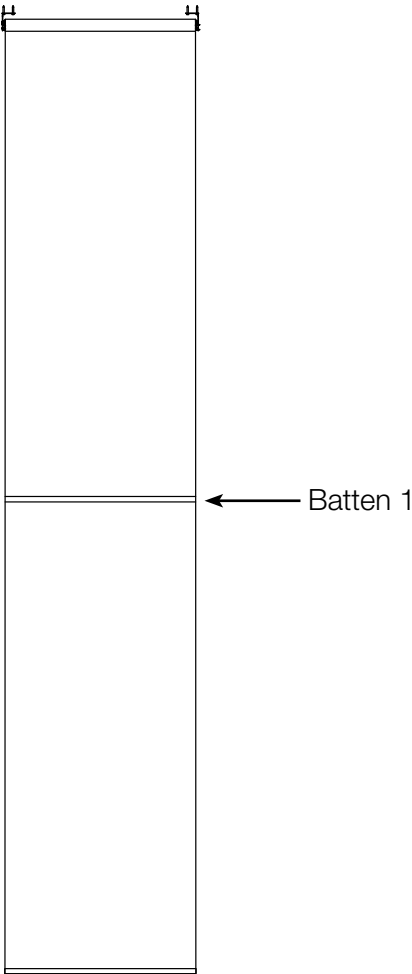

Shade heights of 25 ft (7.6 m) to 30 ft (9.1 m) require two (2) battens.

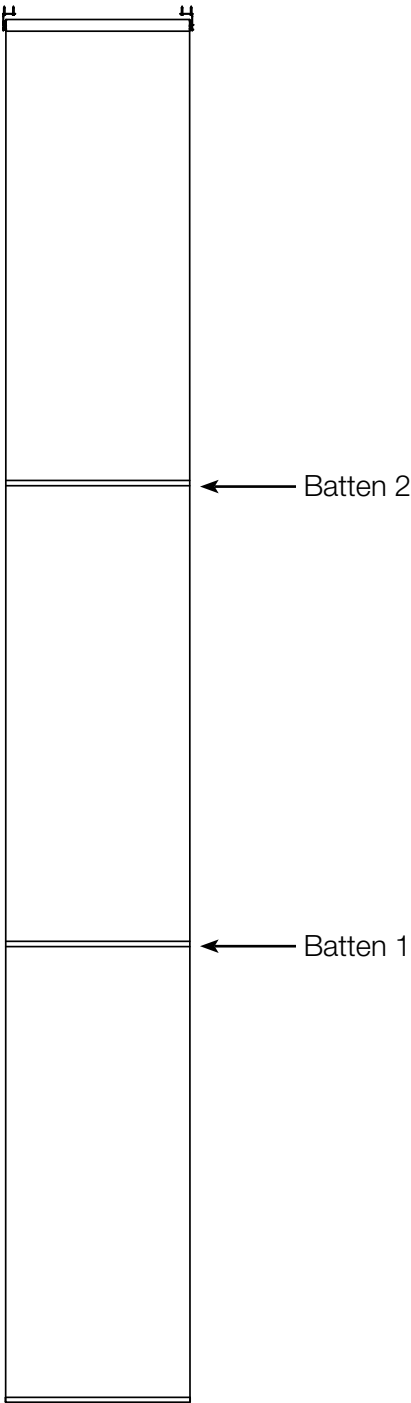

The Lutron logo, Lutron, Roller 300, and Sivoia are trademarks or registered trademarks of Lutron Electronics Co., Inc., in the U.S. and other countries.
All other product names, logos, and brands are property of their respective owners.

 SPECIFICATION SUBMITTAL

Page

Job Name:	Model Numbers:
Job Number:	