

HomeWorks QS System Architecture for 120VAC and 434 MHz regions

HomeWorks QS System Capacities

- 16 processors (max)
- 32 configurable links (max)
 - 32 QS wired links (max)
 - 15 wireless links (max)
 - 32 panel links (max)
 - 10 Ketra N4 Hubs (max)
- 10,000 zones² (max)

¹device — Any system component that requires a single address. The processor reserves a single address on every link. Four addresses are reserved for hybrid repeaters on the wireless link.
²zone — An output. An individual shade or dimmer/RPM/QSG/contact closure output.
 Example: A GRAFIK Eye QS would be one device that could have up to six zones.

Key - Wiring

- Network link (Ethernet)
- QS wired link*
- Wireless link*
- Panel link*
- Ketrinet PLC
- RS-232/RS-485
- Palladium HVAC Controller (3 conductor)
- Shade wiring (4 conductor)**
- Shade wiring (2 conductor)**

*GRX-CBL346S-500 Two pair: one pair #18AWG one pair #18–22AWG twisted shielded
 Pin-out: pin 1 - common, pin 2 - VDC, pin 3 - MUX, pin 4 - MUX

**The wire gauge required for shade power conductors is dependent on shade size and number, wire run length, and power supply type being used. Consult technical specifications of shade equipment for details.

***One pair 22AWG twisted, shielded, Class 2 wires (max home run 500ft. per local control, not to exceed 1000ft. total per bus).

HomeWorks QS Processor

- Processor link — 2 RJ-45 Ethernet ports with built in switch for daisy chaining processors (1 RJ-45 Port with HQP6-1)
- Configurable links (RS-485) HQP6-2 offers two configurable links; HQP6-1 offers one configurable link.
 - QS wired link
 - Wireless link
 - Panel link
- Legacy links (Requires software link license)
 - HWI Keypads
 - Q96/QED Shade Drives
 - GRX/WPM
 - H48 wired dimmer link (not shown)
- No integrated interface cards
- No RS-232 port
- 24VDC powered
- Mounts in low-voltage enclosures and PNL-8

Key - Power

- 1 Line voltage 120VAC
- 2 Low voltage 24VAC
- 3 Low voltage 24VDC
- 4 Low voltage 12VDC
- 5 Plug-in transformer
- 6 Battery powered

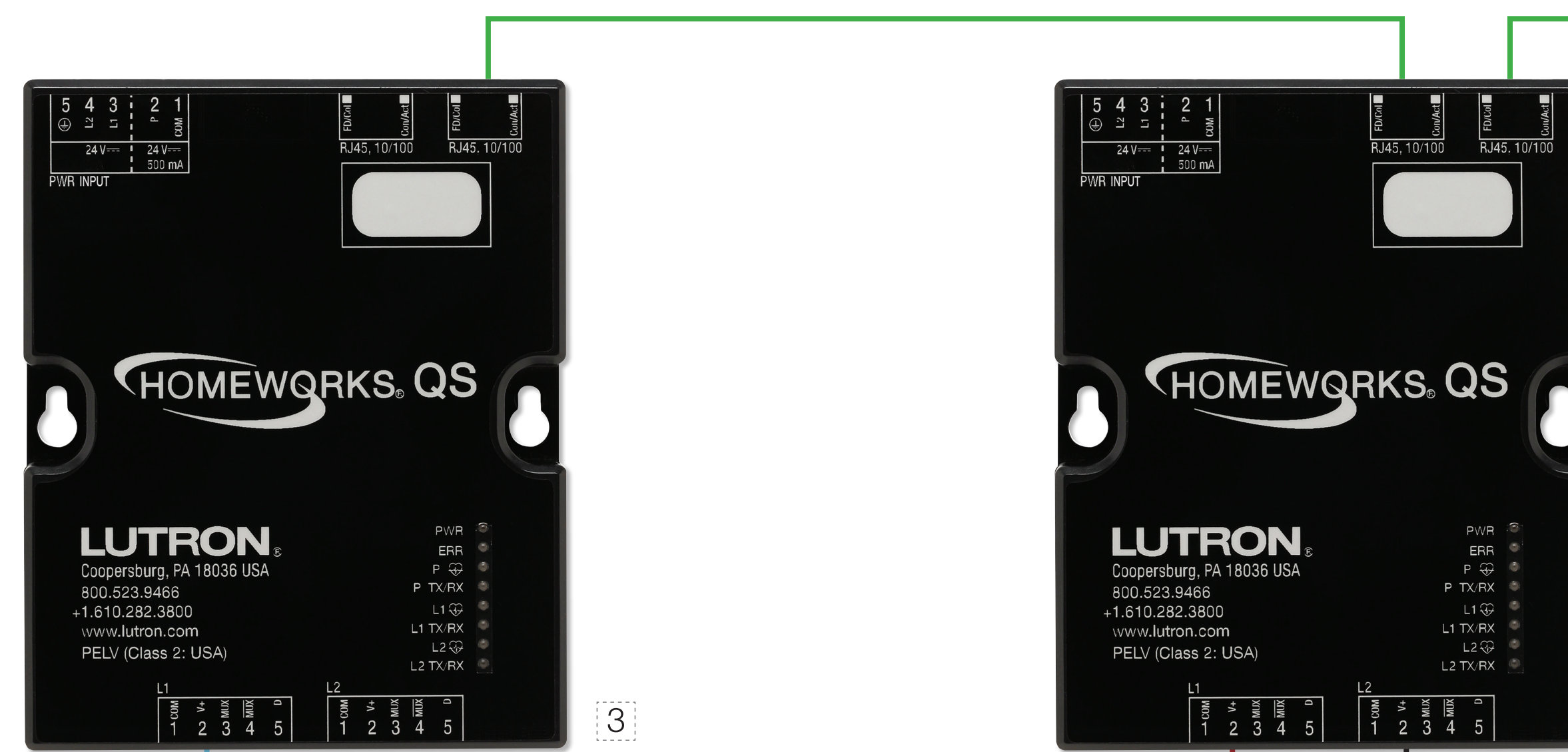

Network Link

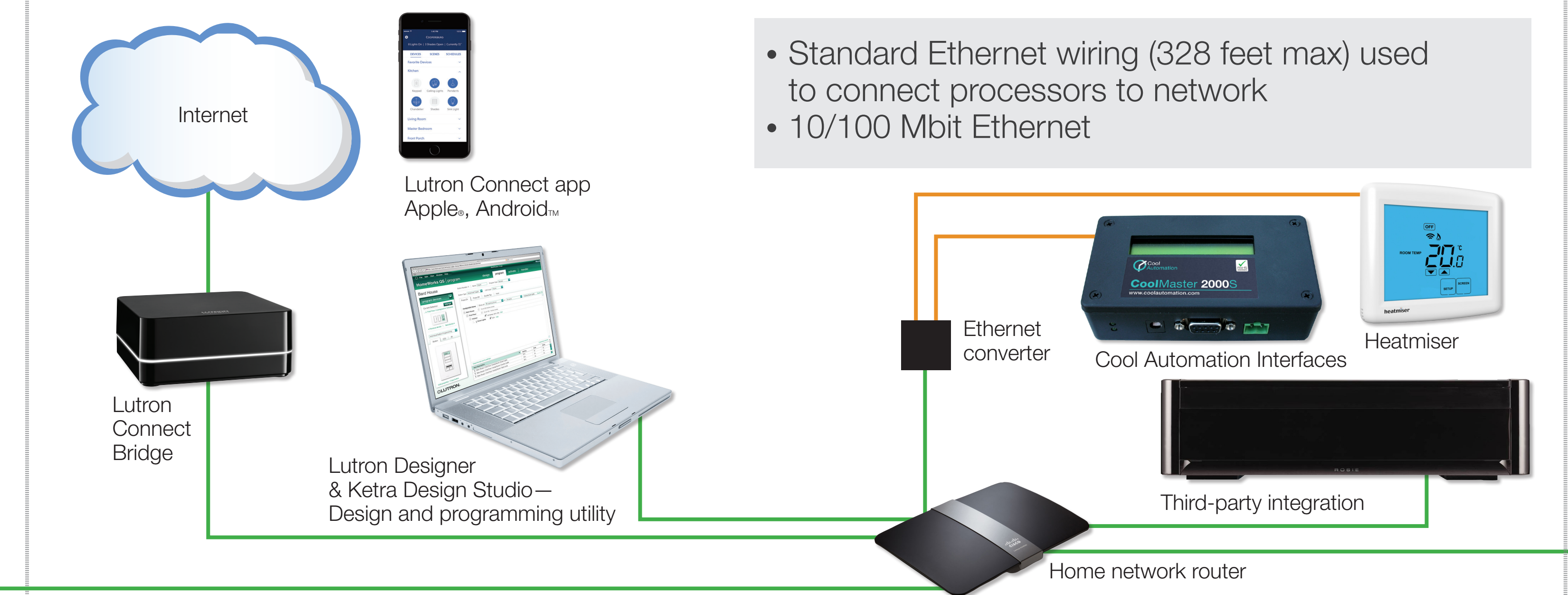

Ketra

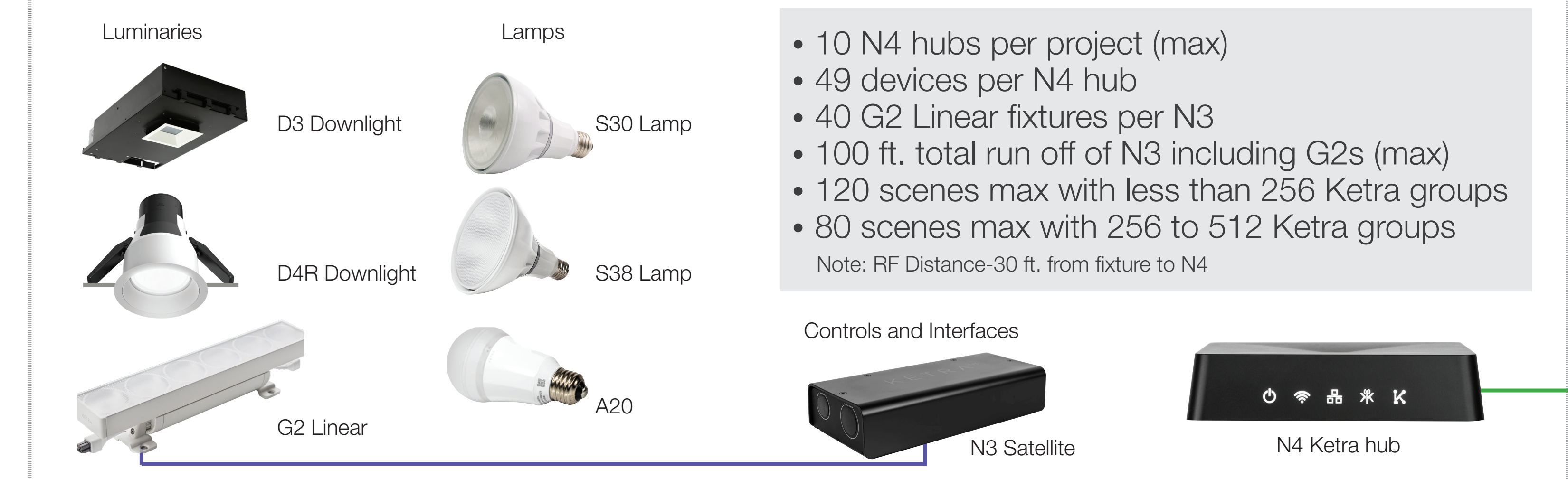

QS Wired Link

- 100 devices¹ per link
- 512 zones² per link
- 2,000 feet maximum wire length (consult technical specs for other applicable rules)
- Free-wire topology (star, daisy chain, home run, etc.)
- Standard Lutron 4 conductor cable*

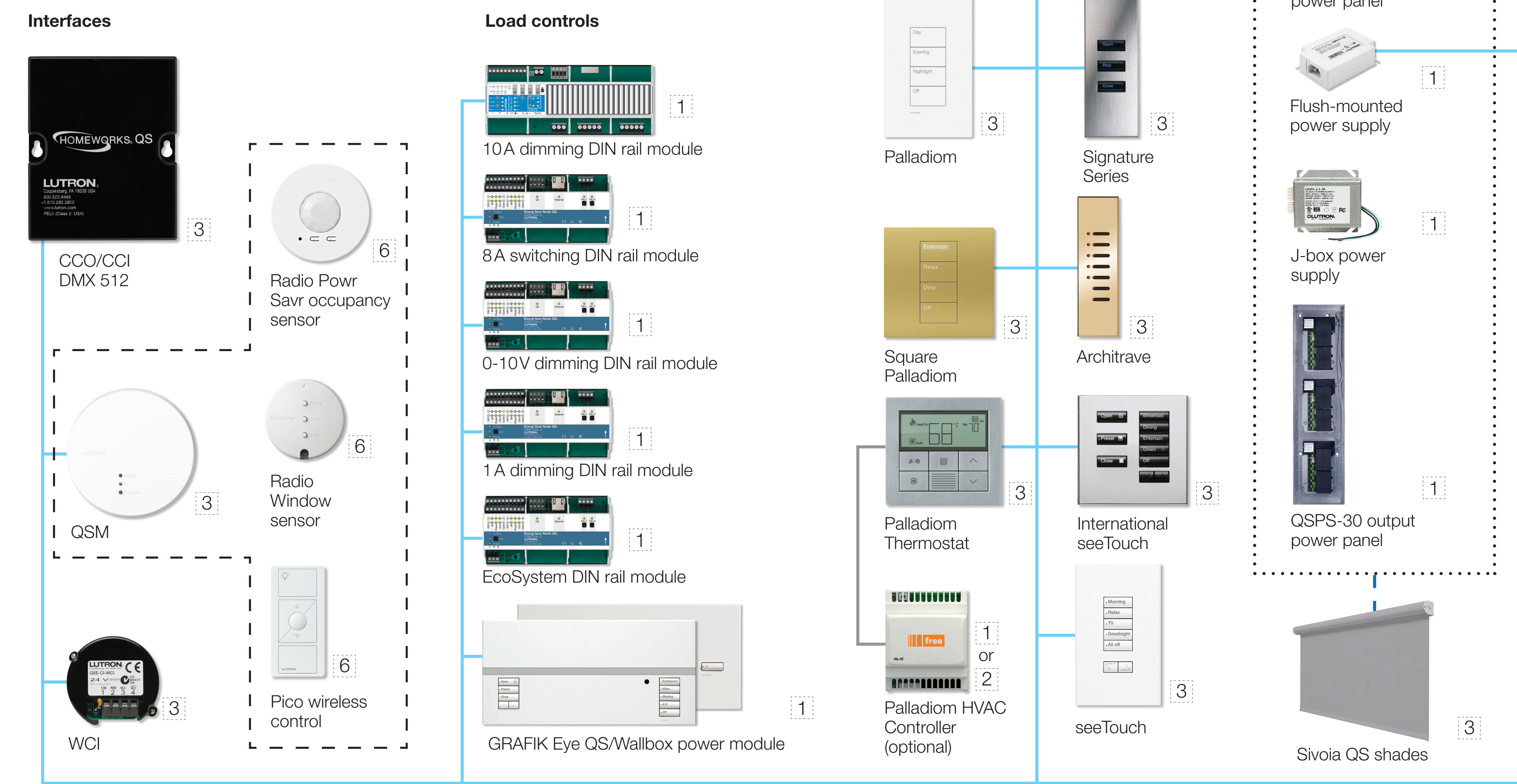

Note: Not all available products are shown.

Panel Link

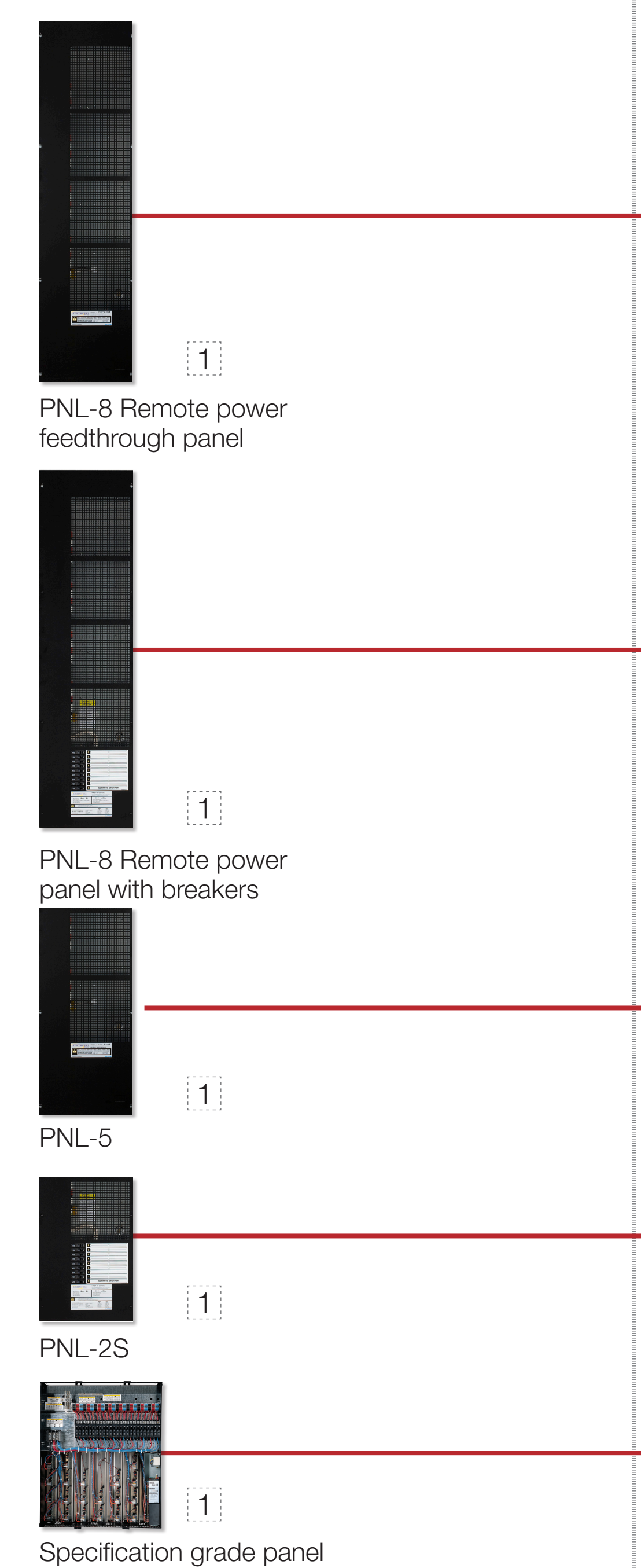

- 16 MIs/SPIs per link
- 256 zones² per link

Wireless Link

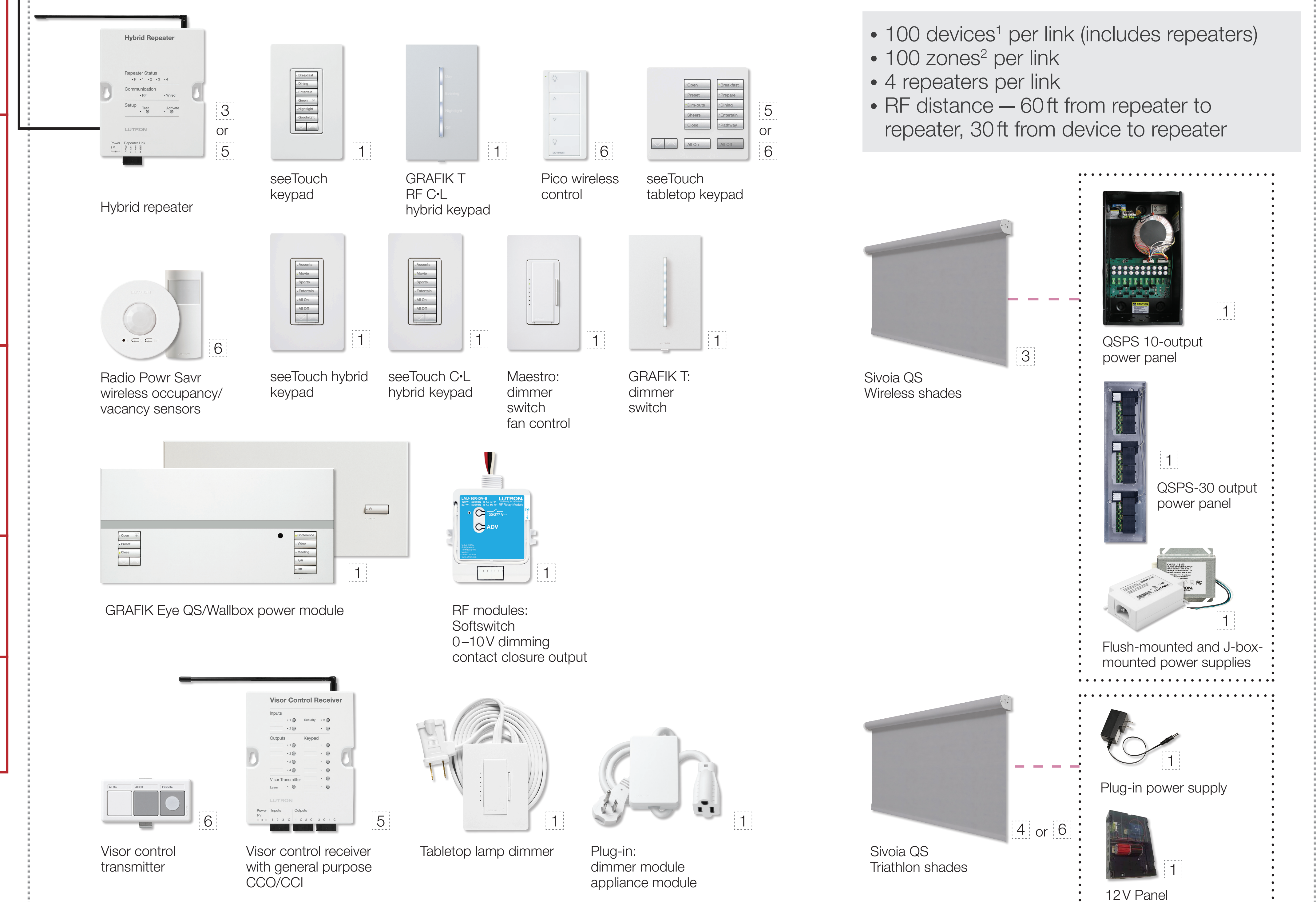

Note: Not all available products are shown.