

Athena System Architecture

QS Wired Link

- **QP5-2L and QP5-4L:** 99 QS devices per link
512 switchlegs per link*
- **QP6-1L and QP5-1L:** 25 QS devices per link
256 switchlegs per link*
- 2,000 feet maximum wire length (consult technical specs for other applicable rules)
- Free-wire topology (star, daisy chain, home run, etc.)
- Standard Lutron 4 conductor cable**

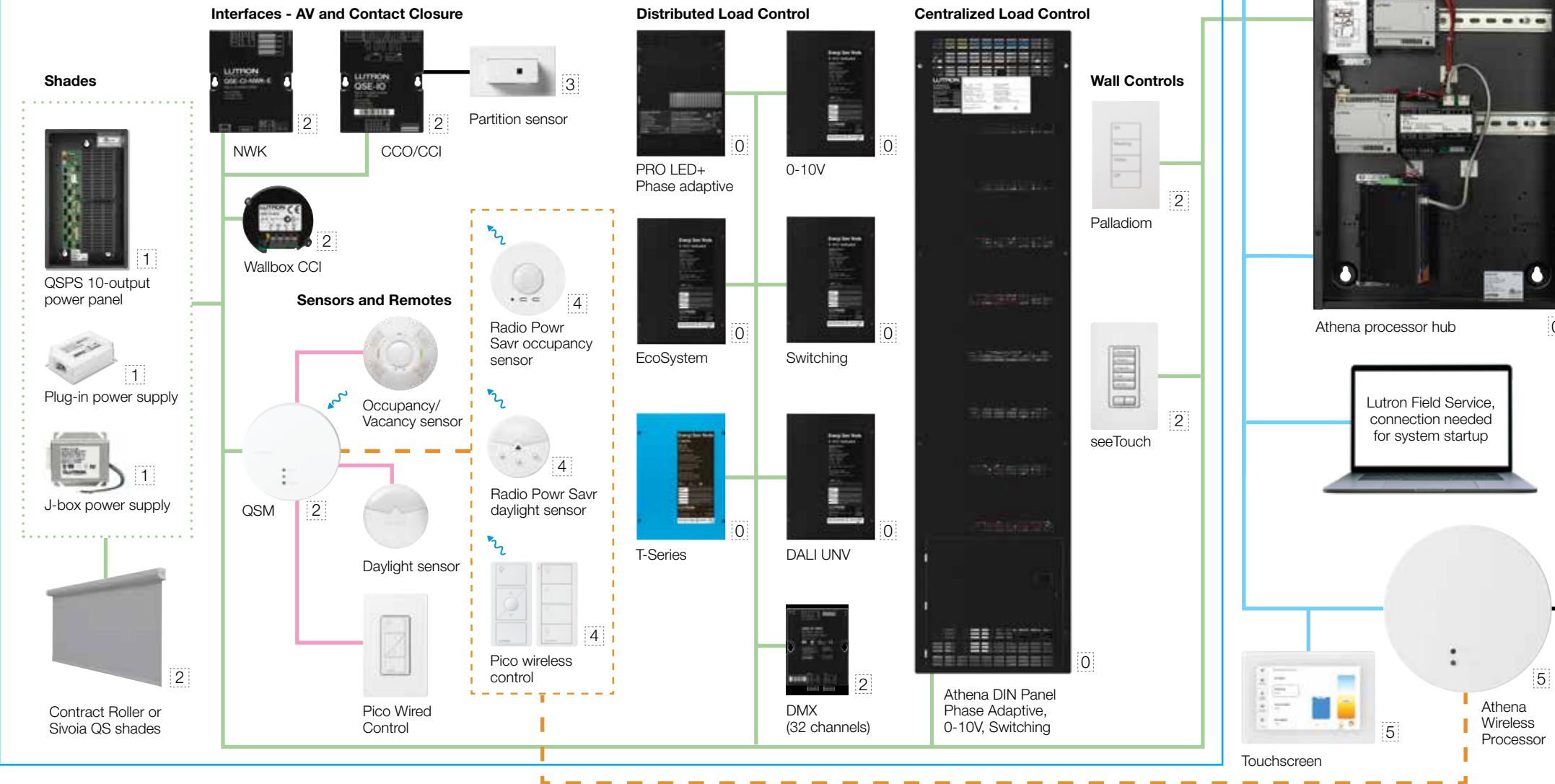

Software

Athena Dashboard



Lutron App



The Athena Dashboard and Lutron App communicate with the Athena processor hub via the cloud.

Clear Connect Wireless - Type X

Ketra Fixtures

Luminaries



D3 Downlight (0)



D4R Downlight (1)

Lamps



S30/S38 Lamp (1)



A20 Lamp (1)

Linears



N3 Satellite (0)



G2 Linear (0)

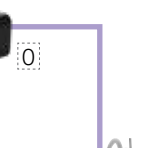

L4R/L31 Office Linear (0)

Third-party Fixtures

Wireless Digital Controller

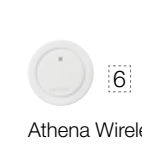

Athena Wireless Node (6)

Note: 100 Clear Connect Type X device per gateway

Athena System Capacities

- 16 total Athena Processors and Clear Connect Type X Gateways (max, any combination) per database.
- 320 Athena Processors and Clear Connect Type X Gateways (max) per building
- 1500 Ketra devices (max)***

*** An N3 counts as 1 device regardless of the number of fixtures connected to it.

Key - Wiring

- **QS Wired Link****
- **QSM Wired Sensor Link**
- - - **Clear Connect Wireless-Type A Link**
- **Ketranet PLC**
- - - **Clear Connect Wireless - Type X Link**
- **System Ethernet Link —**
Ethernet connection between processors and Clear Connect Type X Gateways to the internet required for system startup and app function.

**Pin-out: pin 1 - common, pin 2 - VDC, pin 3 - MUX, pin 4 - $\overline{\text{MUX}}$

GRX-CBL-346S-500 (runs up to 500ft): one pair 18AWG, one pair #18-22AWG twisted/screened

GRX-CBL-46L (runs up to 2000ft): one pair 12AWG, one pair #18-22AWG twisted/screened

RS-485, 24 - 35VDC powered

The wire gauge required for shade power conductors is dependent on shade size and number, wire run length, and power supply type being used. Consult technical specifications of shade equipment for details.

This document is a system architecture overview. Please refer to system and product spec sheets for complete details.

* A switchleg is the smallest controllable point on any product — a single CCO, a zone of 0-10V, or a single digital address for a fixture.

Key - Power

- 0 120 or 277VAC
- 1 Line voltage 120 VAC
- 2 Low voltage 24-35 VDC
- 3 Plug-in transformer
- 4 Battery powered
- 5 Power over Ethernet (PoE)
- 6 Powered by DALI Link

