

Lutron Wireless Repeater

The Lutron wireless repeater expands the wireless range of your Lutron lighting control system for whole house coverage.

Lutron wireless repeaters extend the range of Radio Frequency (RF) signals that are sent between devices. Up to four wireless repeaters can be added to extend the RF range for larger system applications. Each wireless repeater has an RF range of 9 m, covering an area of approximately 232 m².

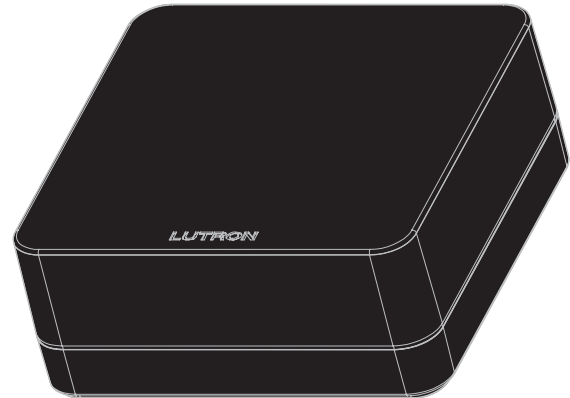

Lutron Wireless Repeater

Features

- Expands RF range
- Can pair with an existing RA2 Select system through the Lutron App¹ or existing RadioRA 3 system using Lutron Designer software
- Can add up to four wireless repeaters per system

Model Number

Wireless Repeater with Power Supply	Country / Region	Frequency Band
LK-REPPRO-BL	United Kingdom and European Union	868 MHz
LM-REPPRO-BL	China	868 Limited
LQ-REPPRO-BL	Hong Kong and Israel	434 Limited
LN-REPPRO-BL	India	865 MHz

¹ The Lutron App is compatible with iOS and Android devices. See the Apple App Store and Google Play for the minimum version requirements.

Lutron Wireless Repeater

Specifications

Power	5 V \equiv 100 mA Power Supply: 5 V \equiv 1000 mA, cable length 1.83 m Field changeable interchangeable AC plugs for United Kingdom and Europe
Typical Power Consumption	<i>Lutron Wireless Repeater:</i> 0.45 W Test conditions: LED on, powered by the 5 V \equiv adapter
Regulatory Approvals	CE, TRA, CITC (LK- model only), and WPC Certified (LN- model only)
Environment	Ambient operating temperature: 0 °C to 40 °C, 0% to 90% humidity, non-condensing. Indoor use only.
Communications	All devices must be located within 9 m of a repeater. All repeaters must be located within 18 m of another repeater.
ESD Protection	Tested to withstand electrostatic discharge without damage or memory loss, in accordance with IEC 61000-4-2.
Surge Protection	Tested to withstand surge voltages without damage or loss of operation, in accordance with IEEE C62.41-1991 Recommended Practice for Surge Voltages in Low-Voltage AC Power Circuits.
Power Failure	Power failure memory: should power be interrupted, the Lutron wireless repeater will return to its previous state prior to the interruption when power is restored.
Connections	USB (power only)
Warranty	www.lutron.com/TechnicalDocumentLibrary/Intl_Warranty.pdf

Lutron Wireless Repeater

Dimensions

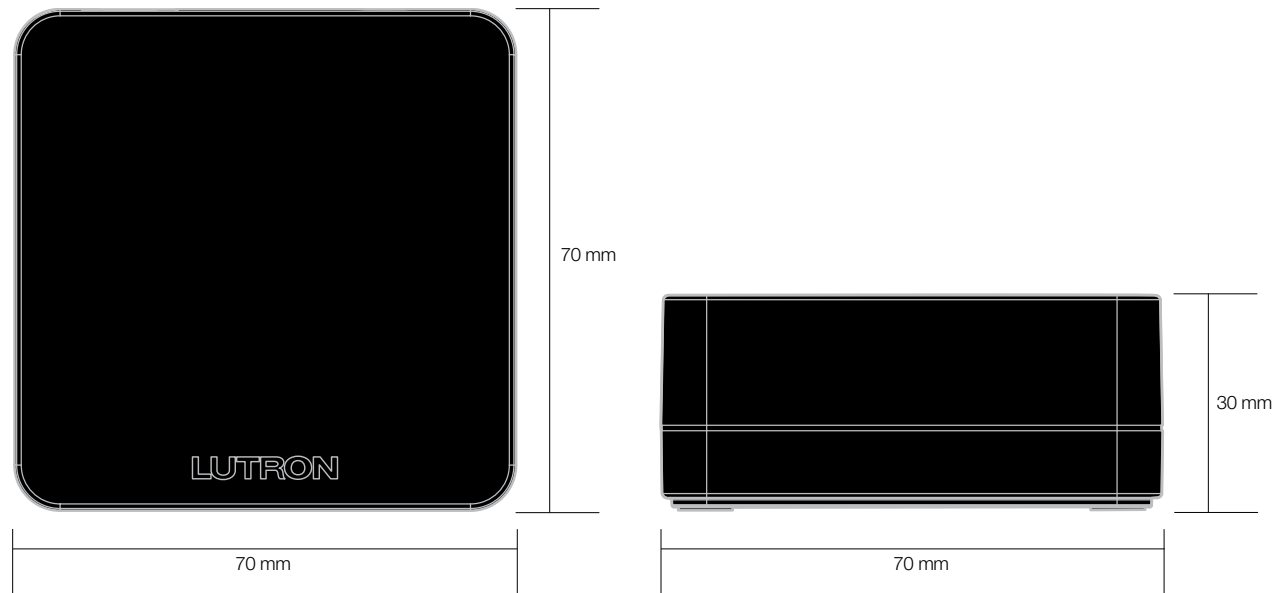

Lutron Wireless Repeater

Connections

Back View

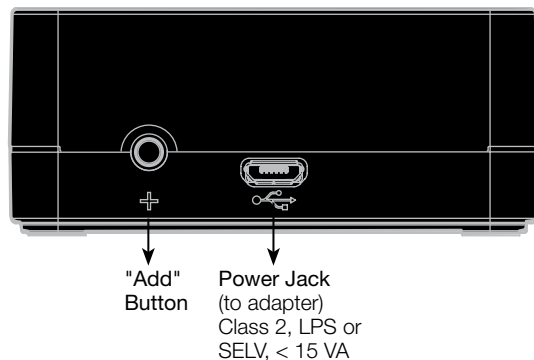

RF Range

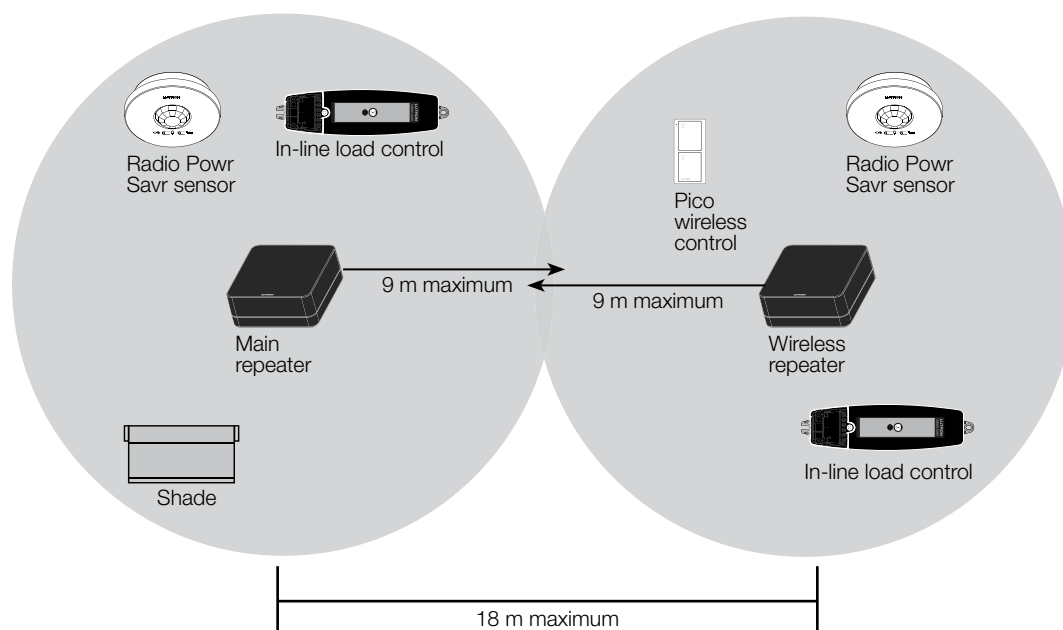

All devices must be located within 9 m of a repeater. The range can be extended with up to 4 Lutron wireless repeaters (Lx-REPPRO-BL).

Lutron Wireless Repeater

RF Range (*continued*)

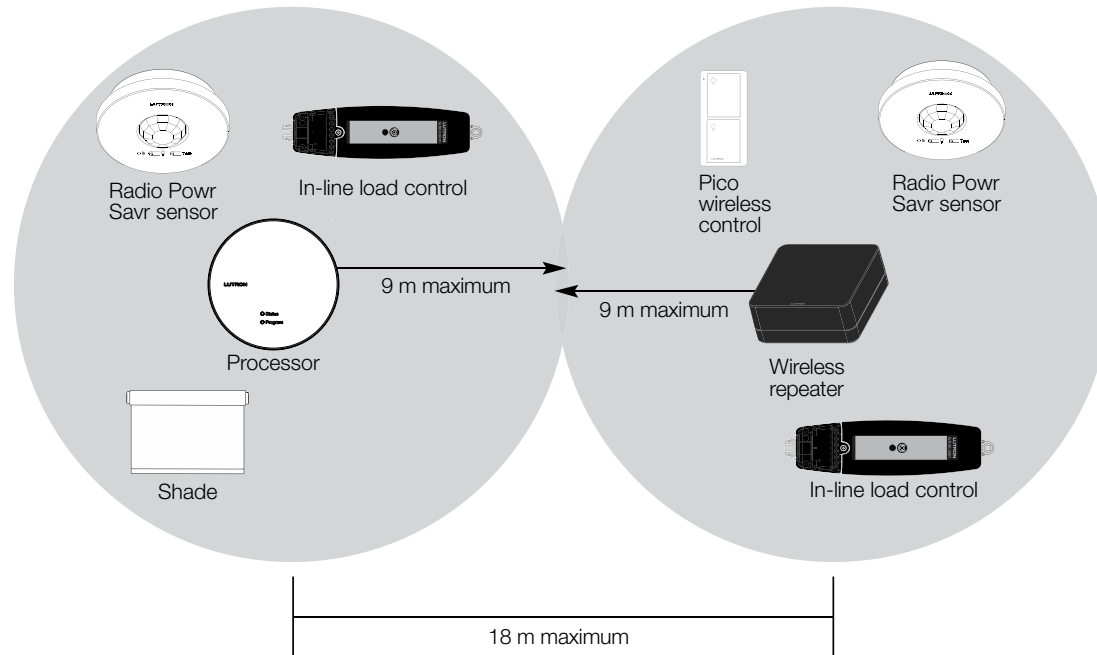

All devices must be located within 9 m of a RadioRA 3 processor or repeater. The range can be extended with up to 4 Lutron wireless repeaters (Lx-REPPRO-BL).

Lutron, Pico, RA2 Select, RadioRA 3, and Radio Powr Savr are trademarks or registered trademarks of Lutron Electronics Co., Inc. in the US and/or other countries.

Apple is a trademark of Apple Inc. registered in the U.S. and other countries. App Store is a service mark of Apple Inc.

Google Play and Android are trademarks of Google Inc.

All other product names, logos, and brands are property of their respective owners.