

Pico Line-Powered Wireless Control

The Pico line-powered wireless control is a flexible and easy-to-use device that allows the user to control Lutron wireless load-control devices from anywhere line voltage power is present in the space. This control requires connection to line voltage for power, but needs no wires for communication.

Features

- Provides control for the following:
 - Vive systems and compatible controls, including:
 - Maestro Wireless controls
 - PowPak modules
 - Wireless fixture controls
 - Wireless receptacle controls
- Powered by line voltage – supports applications that may require compliance to 2023 NEC, 210.70
- Can provide wireless control of lighting devices within a range of 30 ft (9 m) through walls and 60 ft (18 m) line-of-sight.
- Control available in Gloss finishes.
- This product is TAA compliant.
- Wallplate adapter / wallplate purchased separately (Claro wallplate [CW-1] shown).

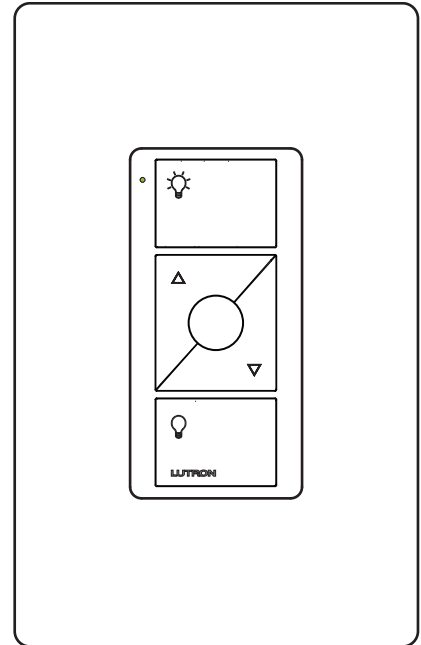

Pico line-powered wireless control

Job Name:

Model Numbers:

Job Number:

Specifications

Regulatory Approvals

- Lutron Quality Systems registered to ISO 9001:2015
- cULus
- FCC Certified (U.S.A.)
- IC Certified (Canada)
- IFETEL Certified (Mexico)
- NOM (Mexico)

Power

- 120–277 V~ 50/60Hz
- Maximum power consumption 0.5 W

System Communication and Capacity

- Communicates using Radio Frequency (RF) at 431 MHz to 437 MHz.
- Thousands of system addresses prevent interference between systems.
- Can be assigned to control lighting and receptacle control devices that are within a range of 30 ft (9 m) through walls and 60 ft (18 m) line-of-sight.
- Range can be extended by use of a Vive hub.

Environment

- Ambient operating temperature: 32 °F to 104 °F (0 °C to 40 °C)
- Maximum 90% non-condensing relative humidity
- Indoor use only

Warranty

- 1 Year Limited Warranty
For additional Warranty information, please visit www.lutron.com/TechnicalDocumentLibrary/369-119_Wallbox_Warranty.pdf

Job Name:	Model Numbers:
Job Number:	

Dimensions

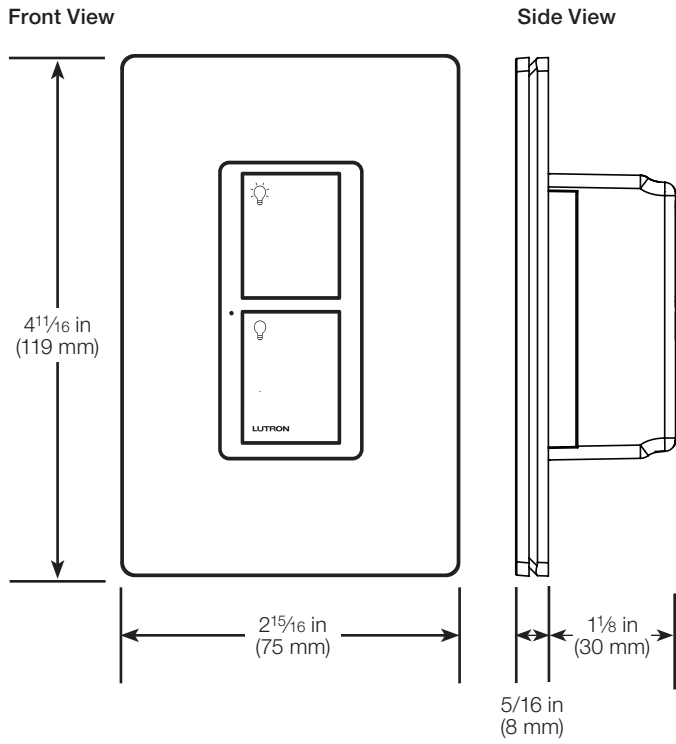

Job Name:	Model Numbers:
Job Number:	

Mounting

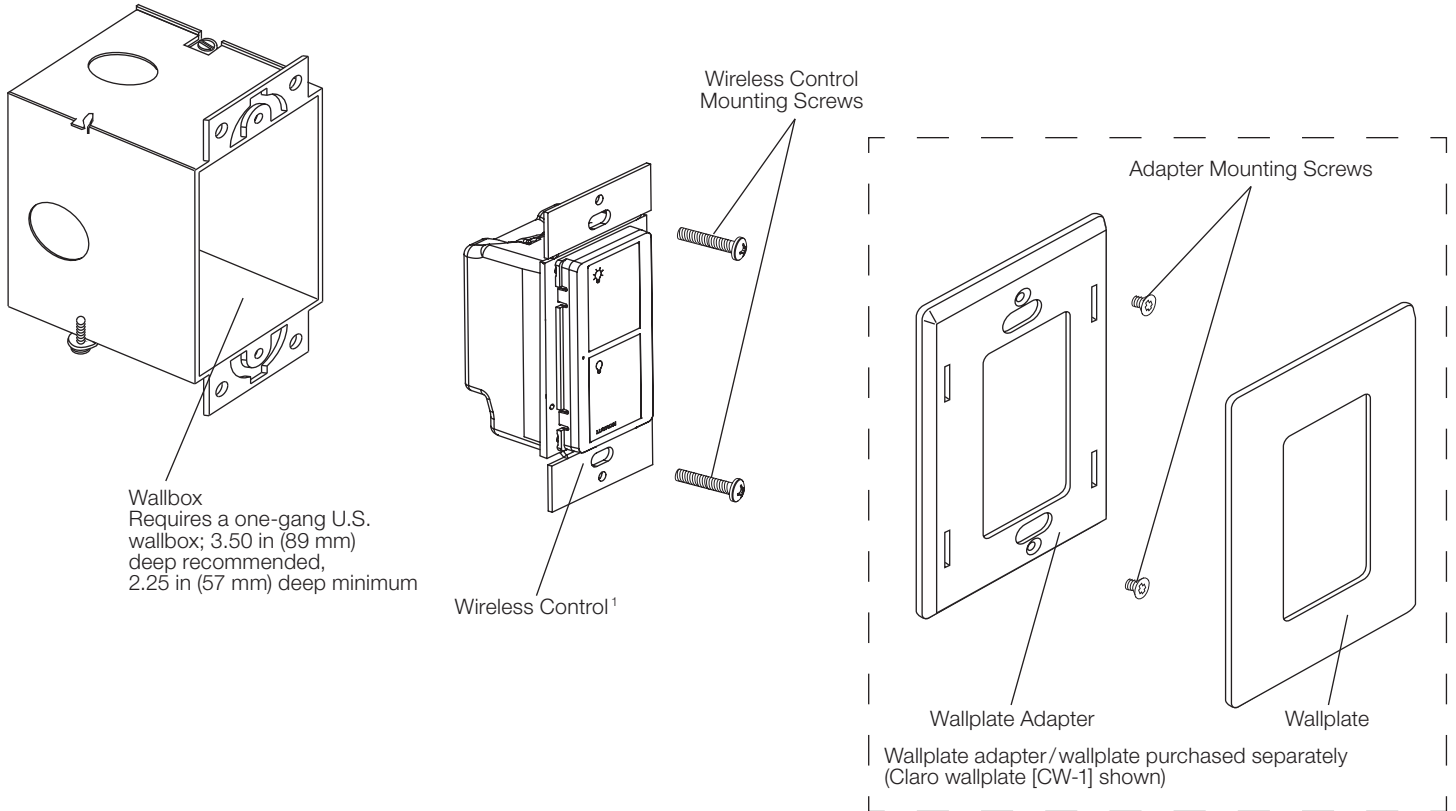

¹ Product does not contain breakable fins. No additional work/derating required when installed next to other wiring devices in a multi-gang wallbox.

Job Name:	Model Numbers:
Job Number:	

Wiring Diagram

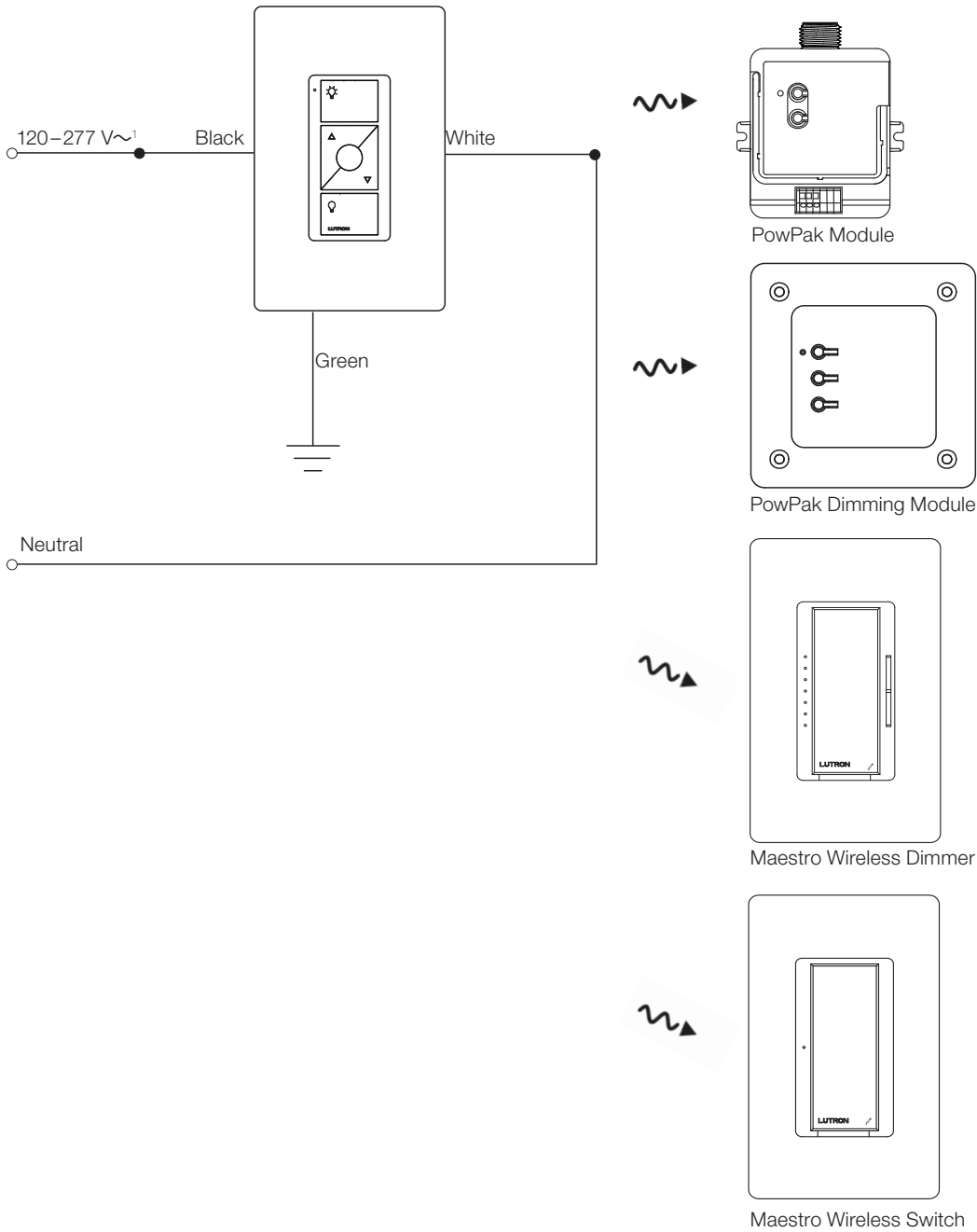

¹ Product wires directly to line-voltage. It does not wire in series with a light fixture, on/off switch, or dimmer.

Job Name:	Model Numbers:
Job Number:	

Operation

2 Button Controls (2B)

Lights Models: L01

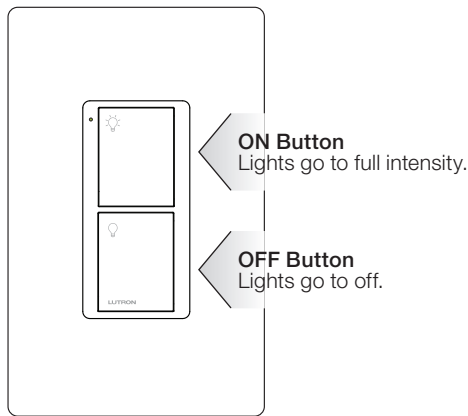

2 Button Controls with Raise/Lower (2BRL)

Lights Model: L01

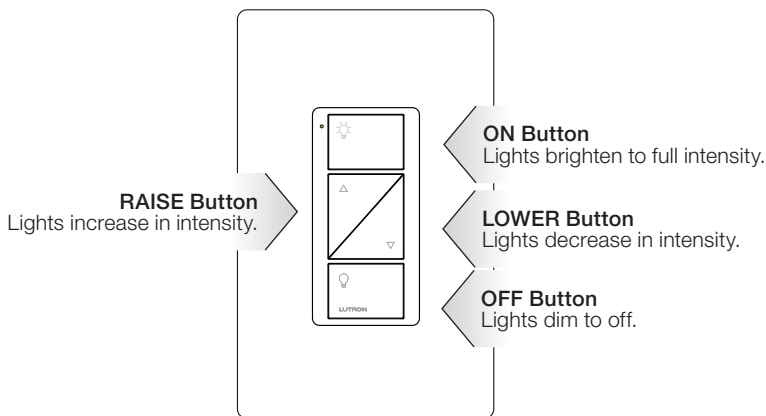

3 Button Controls with Raise/Lower (3BRL)

Lights Models: L01

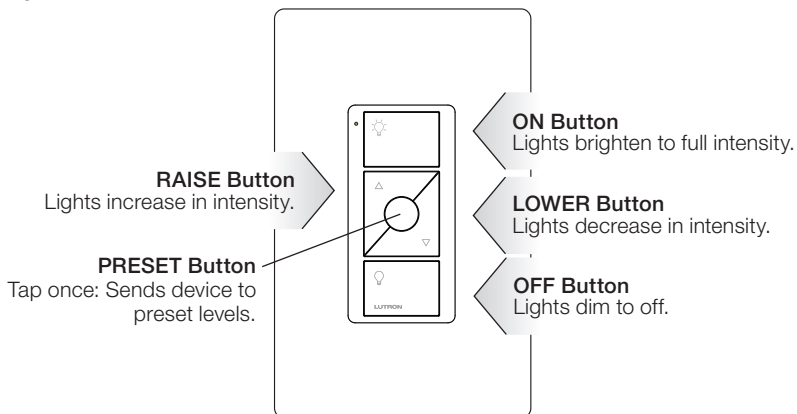

Job Name:	Model Numbers:
Job Number:	

Pico Line-Powered Wireless Control Model Number

P J L – X X X X – X X X – X X X

Frequency/Channel Code *

Code	Frequency Range
J	431.0 – 437.0 MHz

Button Marking Code
(next page)

* For questions about frequency/channel code compatibility, contact your local Lutron sales office or visit us at www.lutron.com

Button Configuration Codes

Code	Button Configuration
2B	2 Button
2BRL	2 Button with Raise/Lower
3BRL	3 Button with Raise/Lower

Color/Finish Codes

Color	Finish
	Gloss
White	GWH
Black	GBL
Ivory	GIV
Light Almond	GLA

(continued on next page...)

Job Name:	Model Numbers:
Job Number:	

Pico Line-Powered Wireless Control Model Number (continued)

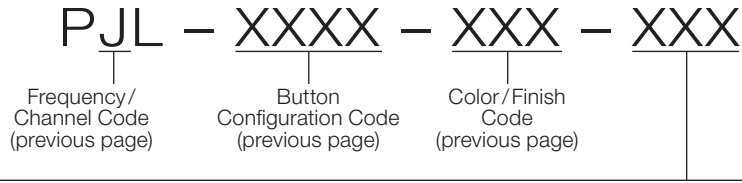

Button Marking Codes

2 Button

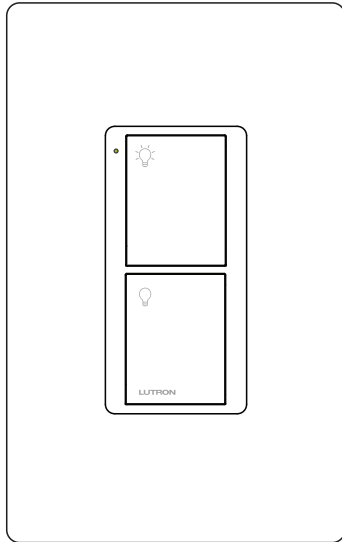

L01: Lights (icons only)

2 Button with Raise/Lower

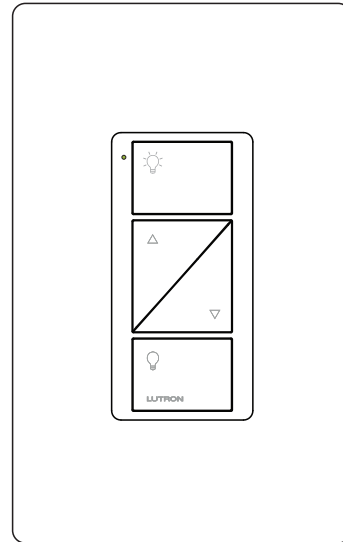

L01: Lights (icons only)

3 Button with Raise/Lower

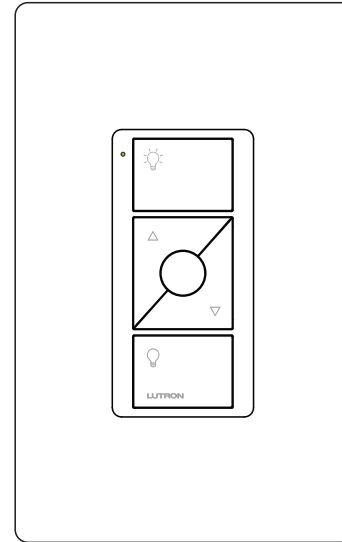

L01: Lights (icons only)

The Lutron logo, Lutron, Vive, Claro, Pico, PowPak, Maestro and the design of the Pico remote are trademarks or registered trademarks of Lutron Electronics Co., Inc. in the US and/or other countries.

All other product names, logos, and brands are property of their respective owners.

Job Name:	Model Numbers:
Job Number:	