

LUTRON®

For Your Information ...



Adjusting the Low End Light Level of a RadioTouch™ Controller

Overview

If your RadioTouch™ Controllers (RTA-RX-F and RTA-RX-F-SC) do not appear to be driving your lighting loads to the specified minimum light level of the dimming ballast being used (Hi-lume® FDB-series to 1% or Eco-10™ ECO- series to 10%) the following two solutions can be used to change that minimum light level.



Important Note: Operating your fluorescent lamps below 1% low end light output when using Hi-lume® FDB- series dimming ballasts can damage the lamp and lead to premature lamp failure. Do not adjust the low end light level for Lutron Hi-lume® FDB- series 1% ballasts unless you are sure that you are well above this 1% minimum level.

Solution 1

Trimming the low end light level on the RadioTouch™ Controller.

The low end light level of the Controller can be adjusted to a new desired level using the RTA-WX-5B-WH or any lighting Tabletop Transmitter that is addressed to the Controller .

RTA-WX-5B-WH or Tabletop Transmitters

Step A - Press the programming button on the Controller. After the button is pressed the lights will cycle up and down for 3 seconds to notify you that you are in programming mode, and settle at 50% light output. The Status LED will be in *fast blink* mode.

Step B - While in programming mode press the 5th and lower buttons on the transmitter column you wish to adjust and hold them for 5 seconds. When the Controller has entered low end trim mode, the lights will flash and settle at the low end.

Step C - Use the raise/lower buttons in the column you are adjusting to put the lights at the new low end light level.

Step D - Press the program button again to exit from program mode. The lights will go to high end and the Status LED will return to *slow blink* mode. The lights should go to the new high end once the receiver is removed from program mode.

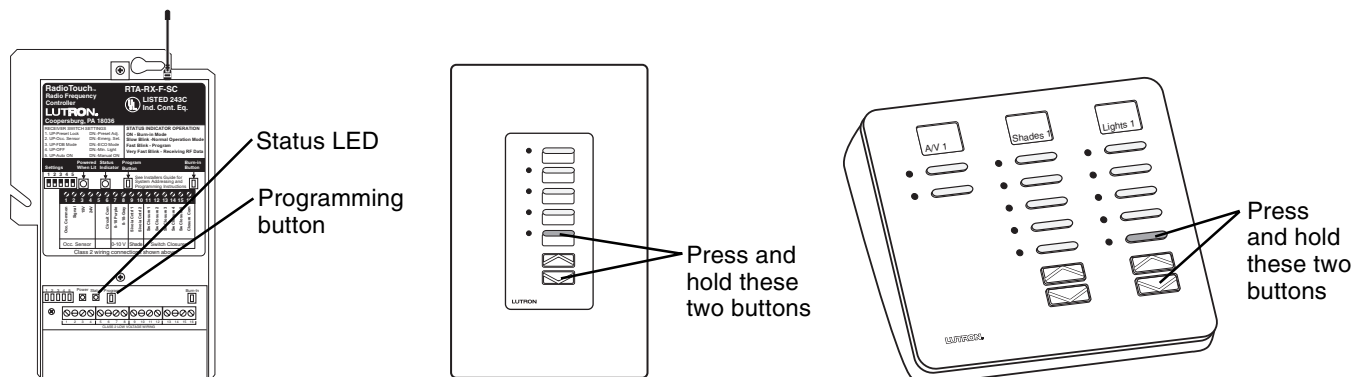

Solution 2

Setting the RadioTouch™ Controller to work with Eco-10™ ECO- series dimming ballasts.

The RadioTouch™ Controller will drive the Lutron fluorescent dimming ballasts to a lower light level in ECO mode. To enter ECO mode, flip DIP switch #3 to the down position and the low end light level will be reduced to 10%.

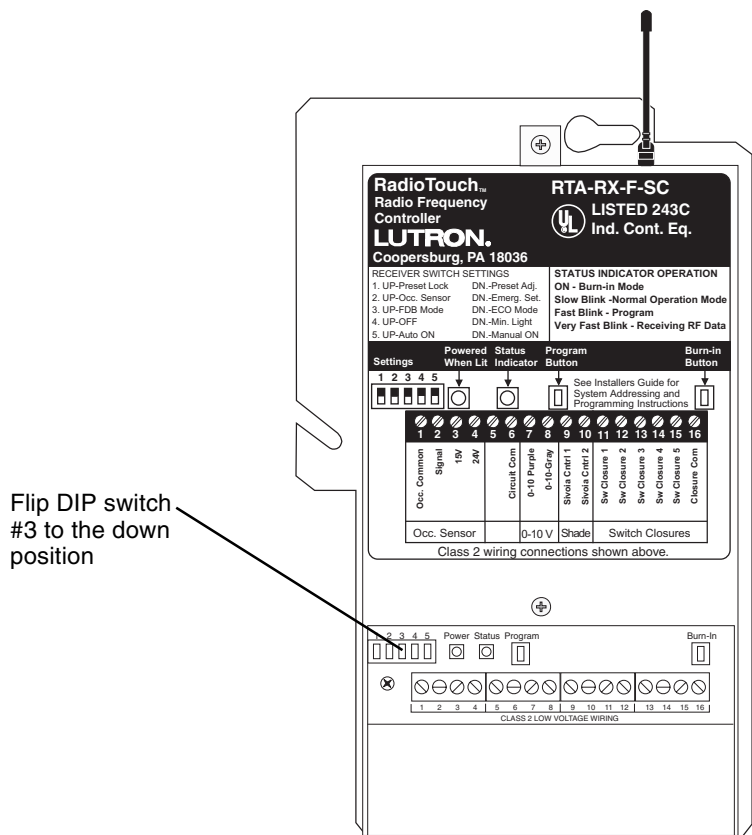

Worldwide Technical and Sales Assistance

If you need assistance call the toll-free **Lutron Technical Support Center**. Please provide exact model number when calling.
 (800) 523-9466 (U.S.A., Canada, and the Caribbean)
 Other countries call (610) 282-3800
 Visit our web site at www.lutron.com

Lutron Electronics Co., Inc.
 7200 Suter Road
 Coopersburg, PA 18036-1299 U.S.A.
 Phone: (610) 282-3800
 Fax: (610) 282-3090

Lutron, Hi-Lume, and Tu-Wire are registered trademarks and Eco-10, and RadioTouch are trademarks of Lutron Electronics Co., Inc. © 2001 Lutron Electronics Co., Inc.

Need additional assistance? Call the Lutron Technical Support Center 1-800-523-9466

Lutron Electronics Co., Inc.
 7200 Suter Road
 Coopersburg, PA 18036-1299 U.S.A.
 Made and printed in U.S.A. 6/01 P/N 367-xxx Rev. A