

HomeWorks System Architecture for 120VAC and 434MHz regions

HomeWorks System Capacities

- 1 processor and up to 15 additional processors/gateways (maximum of 16 total devices)
- 32 configurable links (max)
 - 32 QS wired links (max)
 - 15 Clear Connect – Type A links (max)
 - 10,000 zones² (max)

¹device — Any system component that requires a single address. The processor reserves a single address on every link. Four addresses are reserved for hybrid repeaters on the wireless link.

²zone — An output. An individual shade or dimmer/QSG/contact closure output. Example: A GRAFIK Eye QS would be one device that could have up to six zones.

HomeWorks Wired Processor

- Processor link — 2 RJ-45 Ethernet ports with built in switch for daisy chaining processors (1 RJ-45 Port with HQP7-1)
- Configurable links (RS-485)
 - QS wired link
 - QS wireless link (Clear Connect – Type A)
- 24 -35VDC powered
- Mounts in low-voltage enclosures, PD4, and PD8 DIN panel

Key - Power

- 1 Line voltage 120VAC
- 2 Low voltage 24VAC
- 3 Low voltage 24-35VDC
- 4 Low voltage 12VDC
- 5 Plug-in transformer
- 6 Battery powered
- 7 Power over Ethernet (PoE)

HomeWorks Dual-Radio Wireless Processor

- Processor link — 1 RJ-45 Ethernet port
- Communication links
 - QS Wireless link (Clear Connect – Type A)
 - Clear Connect – Type X
- PoE or PoE+ powered using an IEEE 802.3af, IEEE 802.3at or IEEE 802.3bt compliant supply

Network Link

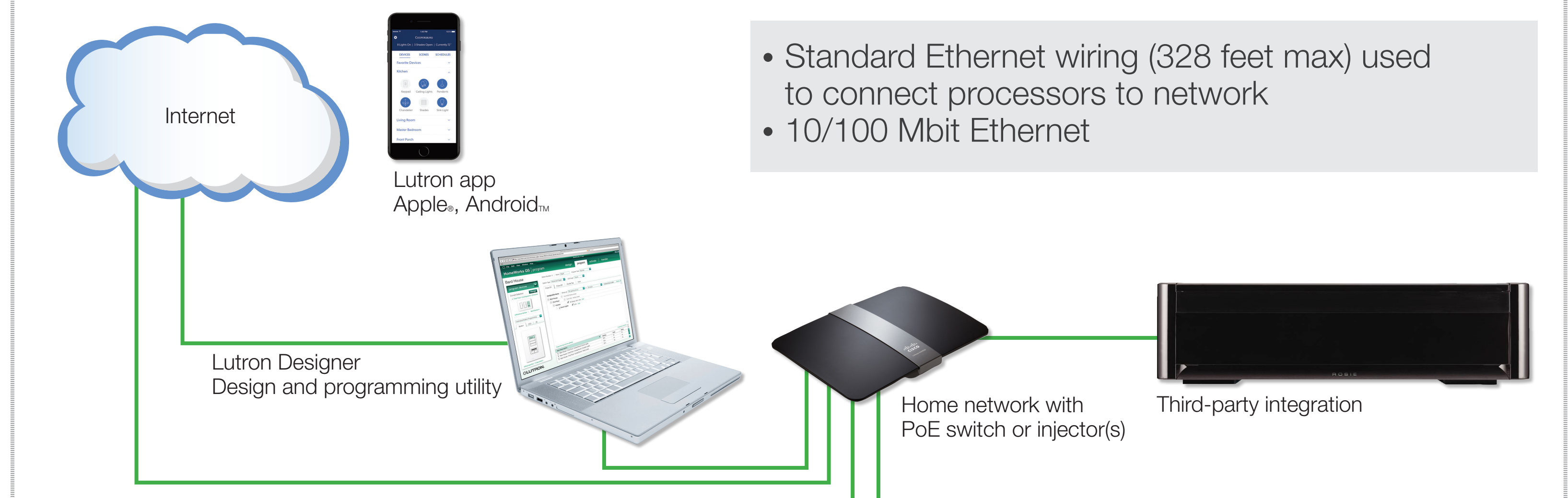

Key - Wiring

- Network link (Ethernet)
- QS wired link*
- Clear Connect – Type A link*
- Ketrinet PLC
- HomeWorks Digital Lighting (2 conductor)
- Palladiom HVAC Controller (3 conductor)
- Shade wiring (4 conductor)**
- Shade wiring (2 conductor)**
- Clear Connect – Type X link for Ketra devices

*GRX-CBL346S-500 Two pair: one pair #18AWG one pair #18-22AWG twisted shielded
Pin-out: pin 1 – common, pin 2 - VDC, pin 3 – MUX, pin 4 – MUX

**The wire gauge required for shade power conductors is dependent on shade size and number, wire run length, and power supply type being used. Consult technical specifications of shade equipment for details.

***One pair 22AWG twisted, shielded, Class 2 wires (max home run 500ft. per local control, not to exceed 1000ft. total per bus).

Key - Power

- 1 Line voltage 120VAC
- 2 Low voltage 24VAC
- 3 Low voltage 24-35VDC
- 4 Low voltage 12VDC
- 5 Plug-in transformer
- 6 Battery powered
- 7 Power over Ethernet (PoE)

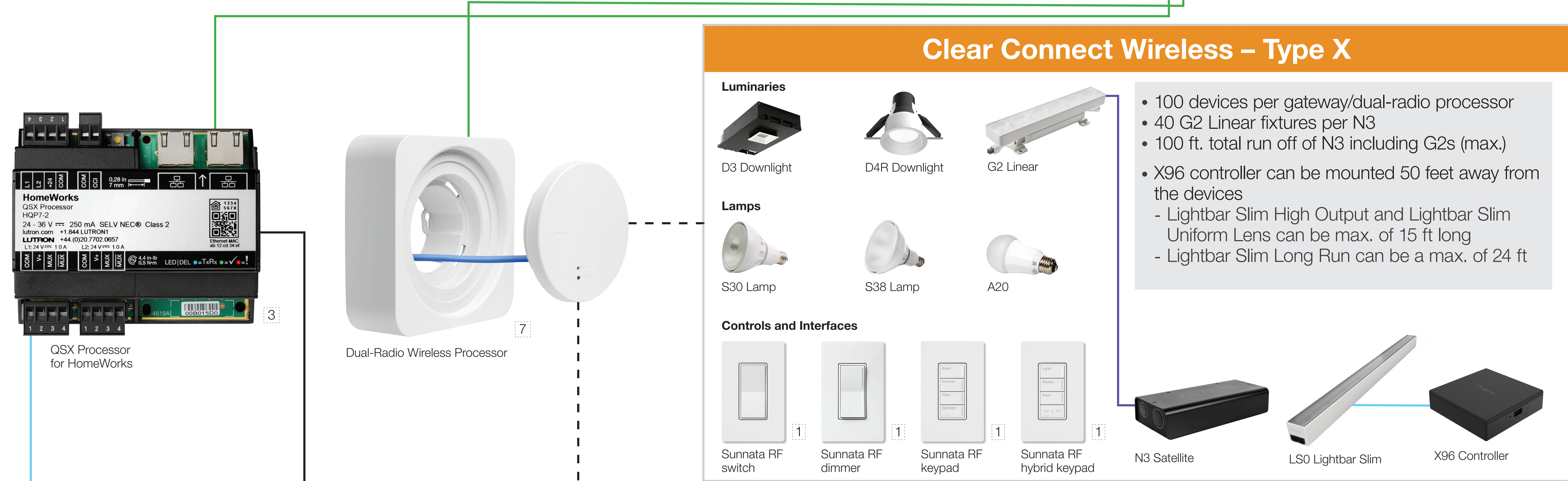

QS Wired Link

- 100 devices¹ per link
- 512 zones² per link
- 2,000 feet maximum wire length (consult technical specs for other applicable rules)
- Free-wire topology (star, daisy chain, home run, etc.)
- Standard Lutron 4 conductor cable*

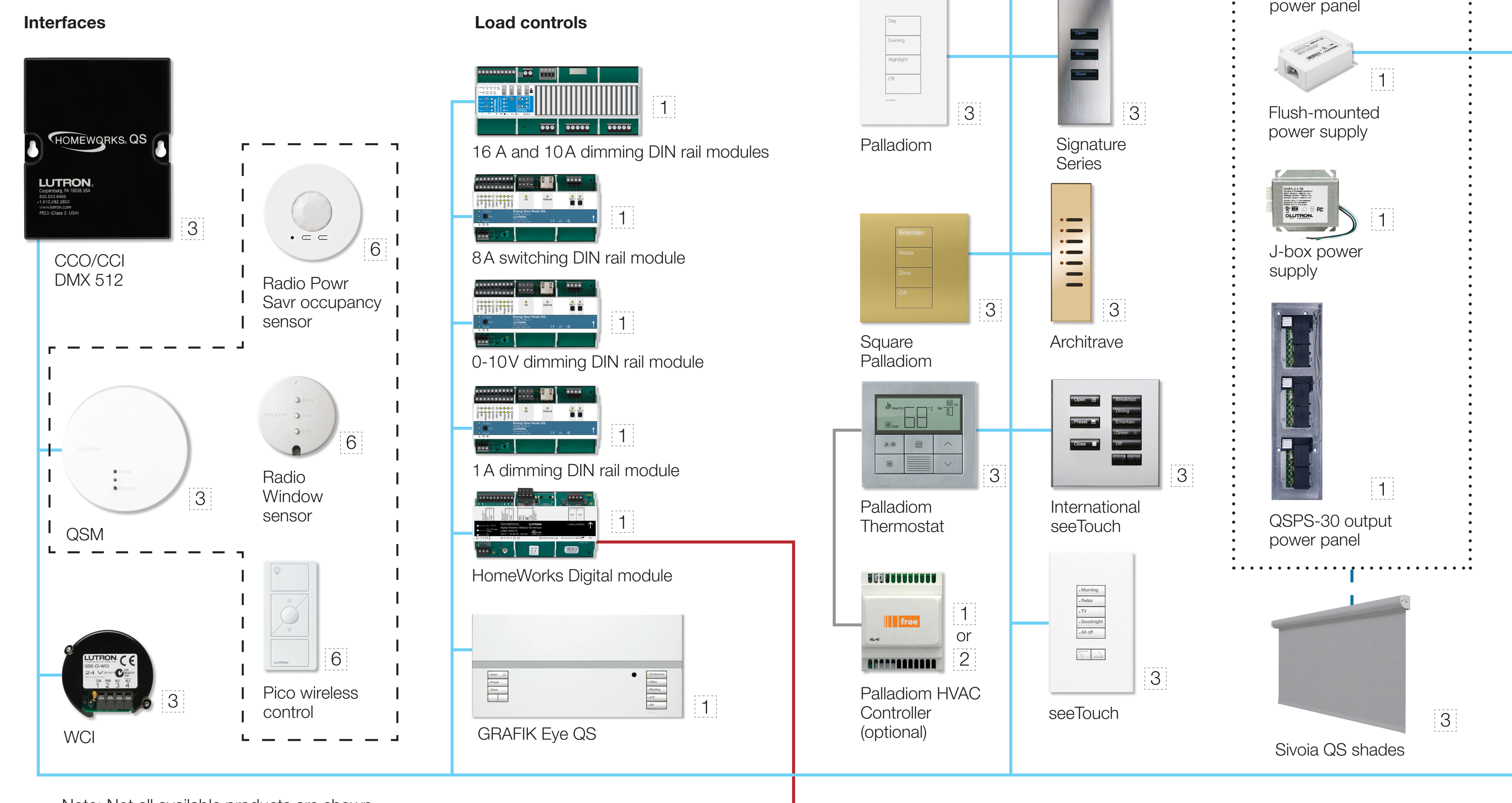

Ivalo Fixtures

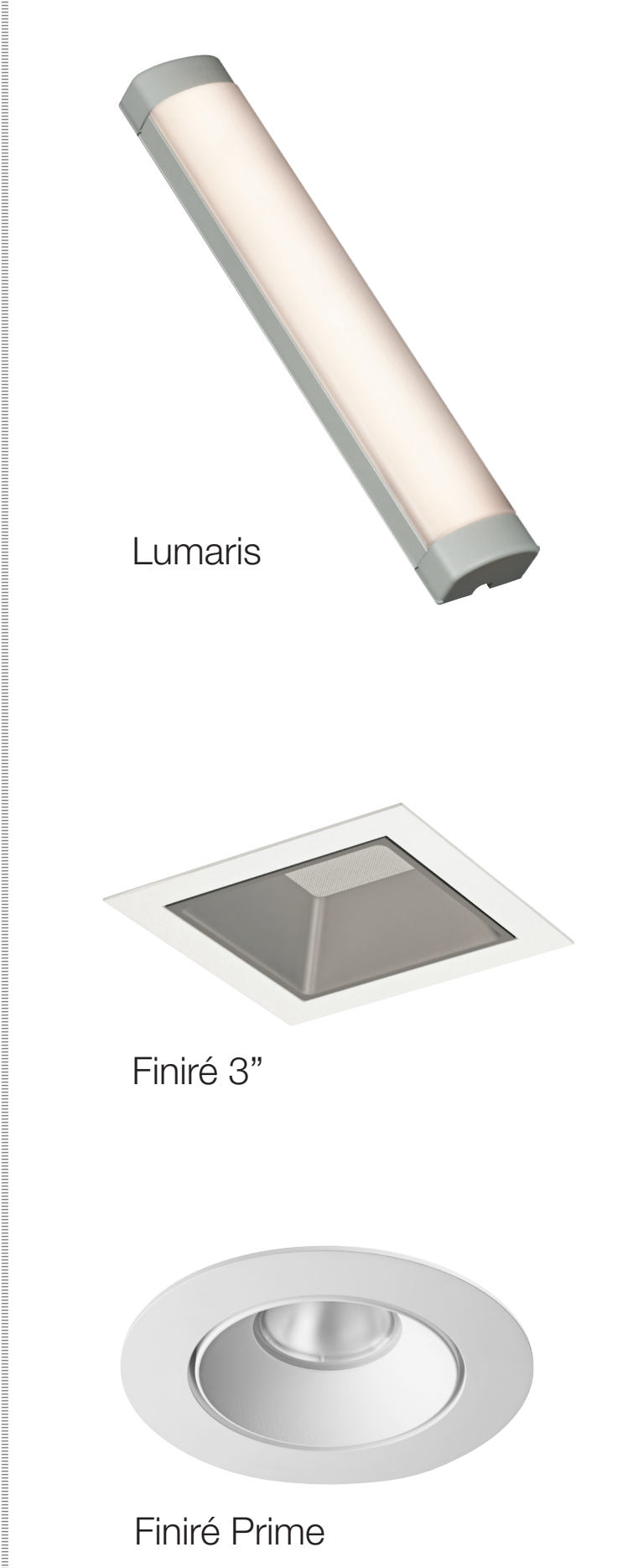

Clear Connect Wireless – Type A

- 100 devices¹ per link (includes repeaters)
- 100 zones² per link
- 4 repeaters per link
- RF distance — 60 ft from repeater to repeater, 30 ft from device to repeater

